

**GLEASON LAKE
ELEMENTARY
FRONT ENTRY
IMPROVEMENTS**

310 COUNTY RD 101,
PLYMOUTH, MN 55447

**INDEPENDENT SCHOOL
DISTRICT #284**
13305 12TH AVE N
PLYMOUTH, MN 55447



**WOLD ARCHITECTS
AND ENGINEERS**

50 South 6th Street, Suite 2250
Minneapolis, Minnesota 55402
woldae.com | 612 772 9025

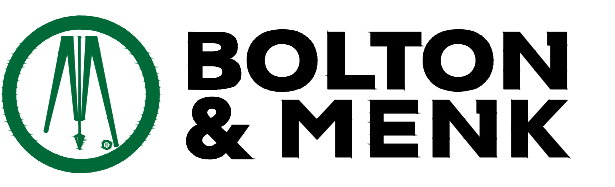

3300 FERNBROOK LANE NORTH, SUITE 300
PLYMOUTH, MN 55447
Phone: (763) 544-7129
Email: plymouth@bolton-menk.com
www.bolton-menk.com

LEGEND

- PROPOSED SOD LIMITS
- PROPOSED SHRUB / MULCH BED

NOTES

1. REFER TO SHEET C2.01, GRADING, EROSION, AND UTILITY PLAN, FOR GENERAL NOTES.
2. ALL DISTURBED AREAS, WHICH ARE NOT DESIGNATED TO BE PAVED, SHALL RECEIVE AT LEAST 6" OF TOPSOIL AND SHALL BE SODDED.
3. WHERE NEW SOD MEETS EXISTING SOD, CUT A CLEAN, SHARP EDGE TO ALLOW FOR A CONSISTENT, UNIFORM, AND STRAIGHT JOINT BETWEEN NEW SOD AND EXISTING TURFGRASS. JAGGED OR UNEVEN JOINTS WILL NOT BE ACCEPTED. REMOVE TOPSOIL AT THE JOINT BETWEEN NEW SOD AND EXISTING TURFGRASS, AS REQUIRED, TO ALLOW NEW SOD SURFACE TO BE FLUSH WITH EXISTING TURFGRASS SURFACE.
4. FAILURE OF TURF DEVELOPMENT: IN THE EVENT THE CONTRACTOR FAILS TO PROVIDE AN ACCEPTABLE TURF, RE-SOD ALL APPLICABLE AREAS, AT NO ADDITIONAL COST TO THE OWNER, TO THE SATISFACTION OF THE ENGINEER OR LANDSCAPE ARCHITECT.
5. ALL PLANT MATERIALS SHALL BE NO. 1 QUALITY, NURSERY GROWN AND SPECIMENS MUST BE MATCHED.

PLANT SCHEDULE

CODE	QTY	BOTANICAL NAME	COMMON NAME	SIZE
DECIDUOUS SHRUBS				
RHAR	10	RHUS AROMATICA "GRO-LOW"	GRO-LOW FRAGRANT SUMAC	#3 CONT.
COSF	11	CORNUS SERICEA "FARROW"	ARCTIC FIRE® RED TWIG DOGWOOD	#3 CONT.
ORNAMENTAL GRASSES				
CAAC	43	CALAMAGROSTIS ACUTIFLORA	KARL FOERSTER FEATHER REED GRASS	#1 CONT.
SPHE	67	SPOROBOLUS HETEROLEPIS	PRAIRIE DROPSEED	#1 CONT.
PERENNIALS				
ECPU	31	ECHINACEA PURPUREA	CONEFLOWER	#1 CONT.
NEFA	37	NEPETA X FAASSENII "WALKER'S LOW"	WALKER'S LOW CATMINT	#1 CONT.

GLEASON LAKE
ELEMENTARY SCHOOL

MN

C

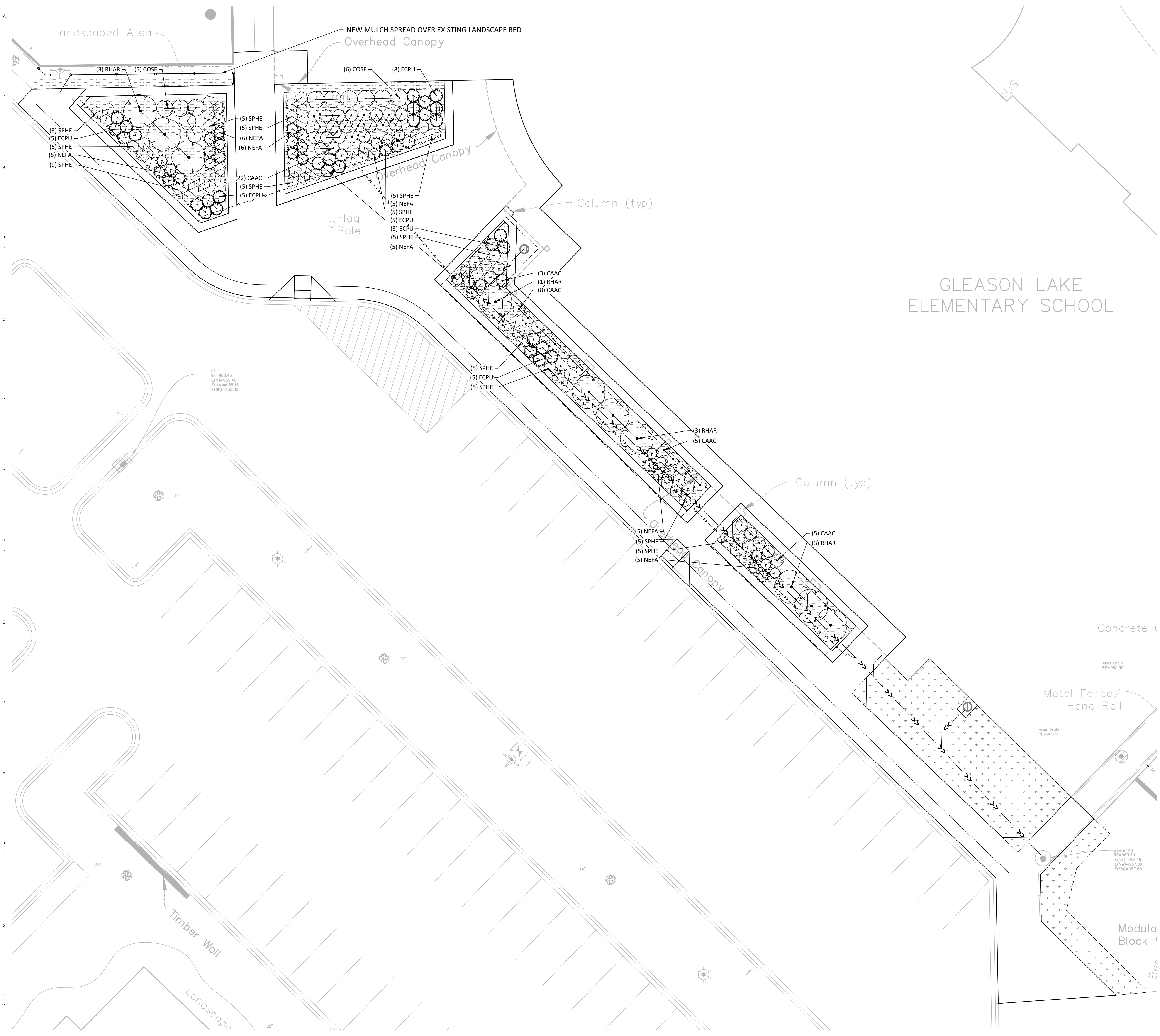

I hereby certify that this plan, specification or report was prepared by me or under my direct supervision and that I am a duly Licensed LANDSCAPE ARCHITECT under the laws of the State of MINNESOTA

JOEL C. ODENS
License Number: 44689 Date: 04/09/2026

Description	Revisions	
	Date	Num

Comm: 262036
Date: 04/09/2026
Drawn: DRP
Check: JCO

LANDSCAPE PLAN

Scale: As Indicated

L1.01

