

Minnehaha Creek Watershed District

REQUEST FOR BOARD ACTION

MEETING DATE: December 15, 2016

ITEM TYPE: Action Consent Discussion

TITLE: Authorization of Cost Share Funding – Standish Ericsson Alley Retrofit

RESOLUTION NUMBER: 16-083B

PREPARED BY: Telly Mamayek

E-MAIL: tmamayek@minnehahacreek.org

TELEPHONE: (952) 641-4508

REVIEWED BY: Administrator Counsel Program Mgr: Telly Mamayek
 Board Committee Engineer Other

WORKSHOP ACTION:

<input type="checkbox"/> Advance to Board mtg. Consent Agenda	<input type="checkbox"/> Advance to Board mtg. Consent Agenda with changes
<input type="checkbox"/> Advance to Board mtg. for more discussion	<input type="checkbox"/> Refer to a future workshop (date): _____
<input checked="" type="checkbox"/> Return to staff for additional work	<input type="checkbox"/> Refer to taskforce or committee (date): _____
<input type="checkbox"/> No further action requested.	<input type="checkbox"/> Advance to CAC mtg. for recommendation

PURPOSE or ACTION REQUESTED:

- 1) Authorize the administrator to execute and sign a cost-share funding and maintenance agreement for the Standish Ericsson Alley Retrofit, not to exceed \$40,000, contingent on staff approval of a project design that is mutually agreed upon by the grant recipients and District staff and signage requirements.

PROJECT/PROGRAM LOCATION:

District Wide

PROJECT TIMELINE:

Spring/Summer 2017

PROJECT/PROGRAM COST:

Fund name and number:	Cost Share Grant Program (4005)
Current grant budget:	\$436,597.59
Amount approved in 2016 to date:	\$163,402.41
Requested amount of funding:	Funding of the approved portion of documented costs of each of the project listed in the attached document, not to exceed a total of \$40,000.

SUMMARY:

The new cost share grant application schedule the Board approved in January provides a spring and a fall deadline for non-homeowner projects and a June deadline for homeowner projects. This allows us to compare like-projects to each other, and prioritize funding on the projects that have the greatest value. By the fall non-

**DRAFT for discussion purposes only and subject to Board action and the availability of funds.
Resolutions are not final until approved by the Board and signed by the Board Secretary.**

homeowner deadline on September 26, 2016, staff received 7 cost share applications. One of the applicants withdrew his application, leaving three community engagement projects and three green infrastructure projects at a total project cost of \$353,534.

The six applications underwent a thorough review process before advancing to the CAC. They were reviewed by Education-Communications staff, the District engineer and a Staff/CAC subcommittee that included planning, project and land management, permitting and education staff. On November 9, 2016, the CAC recommended funding for six of the projects as presented, and changed the recommendation on 2 community engagement projects and 1 green infrastructure project. On December 8, 2016, the Board of Managers advanced five of the projects to the December 15, 2016 consent agenda, but asked staff to provide additional information on the Standish Ericsson Alley Retrofit which was recommended for \$40,000 in District funding.

In the attached memo, you will find a summary of the proposal and funding recommendation. An evaluation scoresheet and plan for the project are also attached. Additional information will be presented at the December 15 board meeting.

EDUCATION VALUE:

Staff sees the installation of stormwater best management practices as a powerful avenue to provide citizen engagement and advocacy opportunities where cities and/or its citizens become participants in and advocates for stormwater management and clean water. Staff also sees them as a way to educate the public on actions that can be taken on an individual citizen scale to improve stormwater management, enhance natural resources and green infrastructure, expand the knowledge base of water resources management, and provide educational opportunities through demonstrative projects within the watershed. Through partnering on these projects, we are gaining stormwater management and investment from public and private property owners on land that we otherwise would not be able to implement projects on alone.

The following is a summary of the project’s education and outreach plan.

Standish Ericsson Alley Retrofit:

- Educational signage
- Local school groups will be monitoring the progress of the pavers and learning about stormwater management
- A dedicated page on the Metro Blooms website will track the project’s progress
- Results will be shared on social media and in newsletters
- Results will be reported to the City of Minneapolis in an effort to encourage policy change

Permanent educational signage would be installed near the project sites on the grantee’s property indicating the contribution of funds from the District and also directing people to the MCWD website. District staff will utilize the project in outreach to highlight the work the District is helping fund in the community.

WATER QUALITY IMPROVEMENT:

The District Engineer has analyzed all of the proposed projects to identify the water quality improvement of each of these projects.

The following table shows the pollutant reductions for the project:

Total number of projects approved:	1
Total number of BMPs and shorelines installed:	1
Total cost for construction of these BMPs:	\$ 98,150
Total MCWD cost share funding contribution:	\$ 40,000
Annual Volume reduction:	46,125 cf

Annual Total Suspended Solids reduction: 391 lbs
Annual Phosphorus reduction: 0.9 lbs

STAFF RECOMMENDATION

The applicant listed in the attached document has applied for funding for their project from the Cost Share grant fund, contingent on a signed grant and maintenance agreement that includes a landscape design plan that is mutually agreed upon by the Cost Share recipients and District staff and provision for signage.

Staff recommends funding the projects listed in the attached document at the above amount.

ATTACHMENTS:

1. Memo-12-12-16-Standish Ericsson Alley Retrofit
2. Project Plan and Evaluation-Standish Ericsson Alley Retrofit

RESOLUTION

RESOLUTION NUMBER: 16-083B

TITLE: Authorization of Cost Share Funding – Standish Ericsson Alley Retrofit

WHEREAS, the Cost Share Program was established by the MCWD to provide funding to property owners to design and install best management practices that will provide educational value as well as reduce the volume and increase the quality of stormwater flowing offsite; and

WHEREAS, Metro Blooms has submitted a proposal for cost-share funding for the construction of stormwater best management practices,

WHEREAS, the MCWD 2016 budget includes funds for the Cost Share Program which has \$436,597.59 currently available; and

WHEREAS, the proposal was reviewed by the Citizens Advisory Committee (CAC) on November 9, 2016, and the CAC has recommended approving the proposal and funding in the amount requested; and

WHEREAS, a summary of the approved project and funding amount was included in the December 8 and 15, 2016 Board of Managers meeting packet information; and

WHEREAS, MCWD staff has reviewed the proposal and the CAC’s comments and recommendations, and finds the proposal to be consistent with the goals of the Cost Share Program and recommends funding the approved portion of the documented costs of the project, not to exceed \$40,000, contingent on a signed grant and maintenance agreement that includes a project design plan that is mutually agreed upon by the applicant and District staff in each case and signage requirements, and

NOW, THEREFORE, BE IT RESOLVED, that the MCWD Board of Managers authorizes the administrator to sign, on advice and consent of counsel, a cost-share funding and maintenance agreement with Metro Blooms for documented costs not exceed \$40,000, contingent on staff approval of a final project design and signage.

Resolution Number 16-083B was moved by Manager _____, seconded by Manager _____.
Motion to adopt the resolution ___ ayes, ___ nays, ___ abstentions. Date: _____.

Secretary Date: _____



MEMORANDUM

DATE: December 12, 2016

TO: MCWD Board of Managers

FROM: Telly Mamayek, Director of Communications and Education

RE: RBA 16-083B Authorization of Cost Share Funding – Standish Ericsson Alley Retrofit

The MCWD administers a Cost Share program to provide incentive for interested parties to construct projects that will improve water quality. Part of the process in approving projects to receive funding is to have the applications reviewed by the Citizens Advisory Committee (CAC).

BUDGET UPDATE

Cost Share 2016 Budget:	\$600,000
Amount Approved to date in 2016:	\$163,402.41
Requested Amount:	\$ 40,000

COST SHARE APPLICATIONS

Metro Blooms’ application for the Standish Ericsson Alley Retrofit project was among six applicants for cost share funding from the District for non-homeowner projects during the fall of 2016. At the December 8, 2016 Board of Managers meeting, staff was directed to come back with additional information about the project. Staff plans to present that additional information at the December 15 meeting.

The new cost share grant application schedule the Board approved in January provides a spring and a fall deadline for non-homeowner projects and a June deadline for homeowner projects. This allows us to compare like-projects to each other, and prioritize funding on the projects that have the greatest value. We received 7 cost share applications by the fall deadline, however, 1 applicant withdrew his application leaving 3 community engagement projects and 3 green infrastructure projects requesting a total of \$261,824 in funding.

The newly adopted program schedule includes a thorough review process. That process was amended, somewhat, for the fall funding round by the departure of the Cost Share Grant Administrator in September. The review process for the fall round included an evaluation of each project by staff and the District engineer and by a CAC/staff subcommittee (made of planning, project and land management, permitting and education/communications staff) that provided recommendations to the CAC. The CAC reviewed and recommended funding 6 projects, changing the staff recommendation on three of them (Big Island, Inc., Greensboro Condominiums, Standish Ericsson Alley Retrofit).

We collaborate with public and private partners to protect and improve land and water for current and future generations.

In this memo, you will find a summary of the proposal to be considered for Board funding approval, and the current funding recommendation. The project evaluation scoresheet and the main project plans are also attached. Additional information that was requested will be presented at the December 15 Board of Managers meeting.

Standish Ericsson Alley Retrofit, 3800-block 21st Ave. S., Minneapolis

A group of five homeowners are working with Metro Blooms to implement pervious pavement and an associated monitoring system in a privately-owned Minneapolis alleyway (spanning 10 residential properties) located in the Hiawatha subwatershed. The pervious alleyway will be one of the first in the SENA neighborhood and will help influence policy change which would allow more permeable paver alleys in Minneapolis and across the Twin Cities.

This project aims to reduce flooding by retro-fitting an alleyway with permeable pavement and a stormwater monitoring system. The two-year monitoring plan was developed by the U of M’s St. Anthony Falls Laboratory and partially funded by Hennepin County. The project will capture runoff from 19,143 square feet of impervious surface and remove 0.9 lbs of phosphorus per year.

The project is in the subwatershed of Lake Hiawatha, which is an impaired waterbody. It complements other District initiatives in the area including the Nokomis Blooming Alleys, work with the newly established Friends of Lake Hiawatha, and the District’s work in the Minnehaha Creek focal geography. For education and outreach, the plan highlights that a sign will be installed on one of the properties closest to the street with the target audience – pedestrian traffic. Monitoring results will be shared with the City of Minneapolis. They will also be shared with partners and on the metroblooms.org website and social media, and newsletter. Other education and outreach activities include tours to interested groups and outreach to local school groups that will be monitoring the performance of the pavers.

The total project cost is \$98,150. The Staff and CAC Subcommittee recommended 75% funding of the requested amount (\$40,000), not to exceed \$30,000. The CAC recommends 41% funding of the total project cost, not to exceed \$40,000.

Project Name	Score (_/100)	Project Cost	Recommended Funding	Suggested Funding	Project Type
Standish Ericsson Alley Retrofit	82	\$ 98,150	\$ 40,000	75% (41%)	Community Engagement

We collaborate with public and private partners to protect and improve land and water for current and future generations.



Cost Share Grant Evaluation Form
Community Engagement Grant

Name of Reviewer: Darren Lochner and Erik Megow (Wenck)
 Date Reviewed: 10-24-16
 CAC-Staff Subcommittee Review: 11-1-16

Applicant: Metro Blooms

Project: Standish Ericcson Alley Retrofit

Total Project Budget: \$98,150

Requested Funding: \$40,000 (leveraged by \$40,000 Hennepin County grant; \$15,000 homeowner match)

Community Engagement Grant: must be designed to produce greater public awareness of ways to improve water quality. These projects use a stormwater BMP as a demonstration to educate the public to build community capacity to grow knowledge and support of stormwater management in the community.

Organization Type: Neighborhood Association, non-profit		
Are the Goals of Project Clearly Outlined? Yes. Implementation of pervious pavement and monitoring system in a privately-owned Minneapolis alleyway (spanning 10 residential properties) located in the Hiawatha subwatershed.		
Past History: Has the applicant applied before? Metro Blooms has applied for other projects in the past, this is the first in the SENA neighborhood		
<i>Project Design (30pts)</i>		
Notes: This project aims to reduce flooding by retro-fitting an alleyway with permeable pavement and a stormwater monitoring system. Working with Metro Blooms, five homeowners are working together to create one of the first permeable alleyways in Minneapolis and will actively monitor its benefits. The monitoring plan was developed by the U of M's St. Anthony Falls Laboratory. The project will capture runoff from 19,143 square feet of impervious surface, provide TSS and phosphorus benefits, including .9 lbs of phosphorus removal per year, while also alleviating local flooding issues.	8/10	Water Resource Improvement to MCWD
	5/5	Innovative Design
	5/5	Budget Detail
	10/10	Maintenance Plan
	Project Design Total: 28 /30	
<i>Education & Outreach (60 pts)</i>		
Notes: The plan highlights that a sign will be installed on one of the properties closest to the street with the target audience – pedestrian traffic. Monitoring results will be shared with the City of Minneapolis. It also will be shared with partners and on the metroblooms.org website and social media, and newsletter. Other education and outreach activities include tours to interested groups and outreach to local school groups.	16/20	Influence within Community
	18/25	Outreach Techniques
	5/10	Visibility of Demonstration
	5/5	Leveraging Other Grant Funds
Education and Outreach Total: 44/60		
<i>Water Resource Prioritization (10 pts)</i>		
Notes: The project area drains to Lake Hiawatha, which is an impaired waterbody. It complements other District initiatives in the area including the Nokomis Blooming Alleys, work with the newly established Friends of Lake Hiawatha, and the District's work in the Minnehaha Creek focal geography.	10/10	Alignment with District Priorities
Water Resource Prioritization Total: 10 /10		

Total: 82 /100

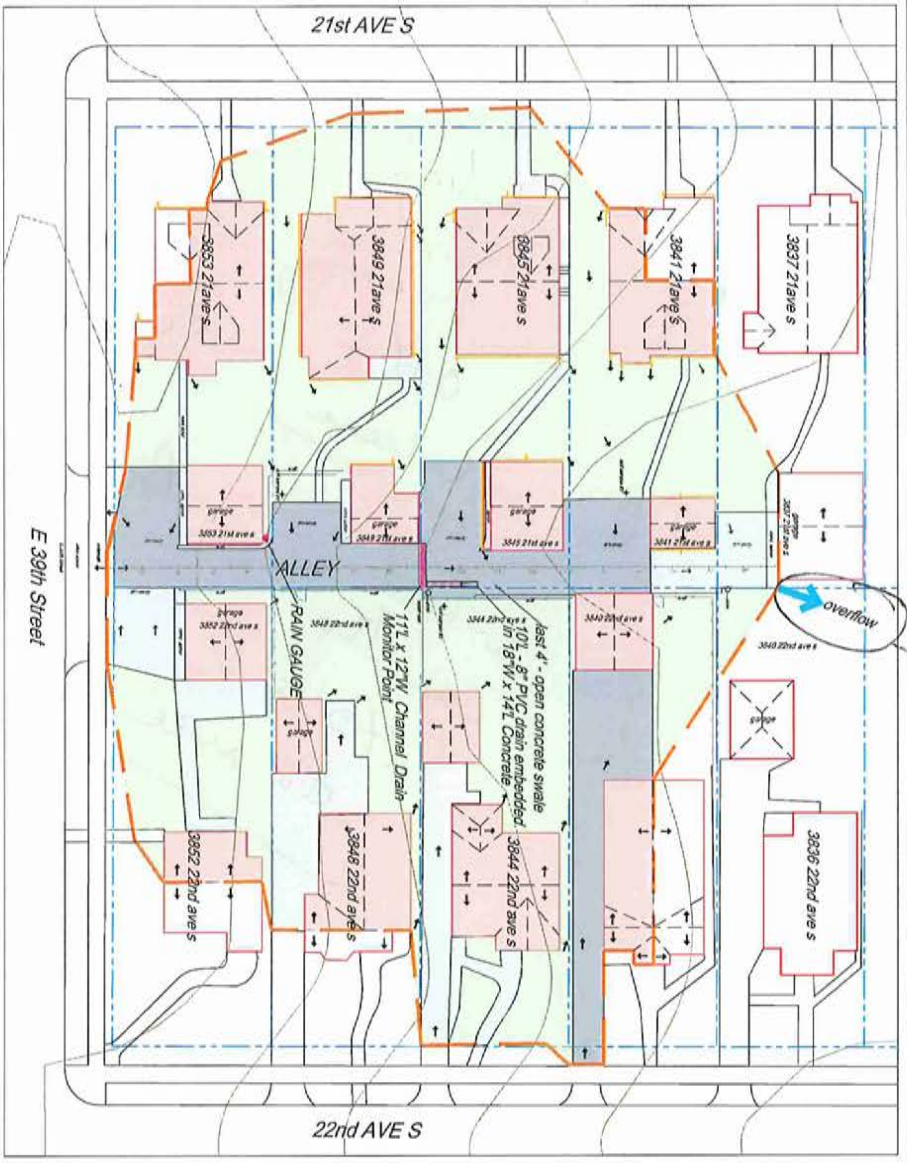

LEGEND

- ASPHALT
- CONCRETE
- BUILDING ROOF
- FLOW DIRECTION
- GREEN SPACE
- ALLEY SHED
- CATCHMENT OUTFLOW
- GUTTER AND DOWNSPOUT
- PROPERTY LINE (APPROXIMATE)

GRAPHIC SCALE

0 5 10 15 20 25 30 35 40 45 50 55 60 65 70 75 80 85 90 95 100

1" = 10'

AREA TABLE

alley/shed	37,072 sf	.851 ac
house/garage disconnected	9,913 sf	.228 ac
garage connected	944 sf	.022 ac
drives disconnected	3,004 sf	.069 ac
drives connected + alley	4,509 sf	.104 ac
walks disconnected	944 sf	.022 ac
lawn	17,758 sf	.408 ac
total impervious =	19,314 sf	.52,1%

Runoff in a 1.27" rain event = 1,493 cf = 11,168 gal
 Runoff in an average year = 34,056 cf = 255,038 gal
 * stormwater modeled using WILSWM v.10.0

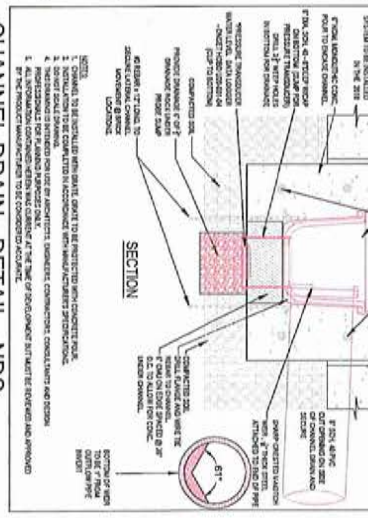
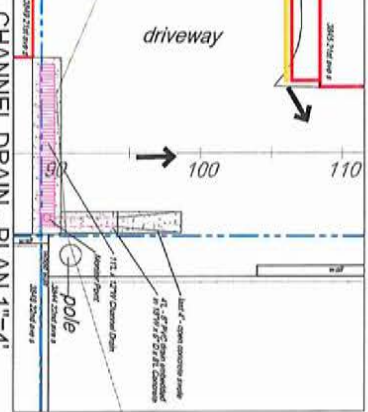

- NOTES:**
- AREAS, LOCATIONS OF STRUCTURES AND SURFACE FEATURES ARE APPROXIMATE AS DETERMINED FROM AERIAL PHOTOGRAPHS, SITE PHOTOGRAPHS AND FIELD MEASUREMENTS.
 - CONTRACTOR RESPONSIBLE FOR LOCATING PROPERTY LINES AND UTILITIES.
- BID NOTES:**
- CONTRACTORS TO PROVIDE BIDS FOR THE FOLLOWING:
 - TRENCH DRAIN, DRAIN SYSTEM, RAIN GAUGE (ONSET HOBO RG3) AND MONITOR HARDWARE AS DETAILED BELOW (INSTALL IN APRIL OF 2017)
 - BASE BID AND/OR ALT BIDS (INSTALL APRIL OF 2018)
 - BASE BID - DEMO DRIVEWAYS AND REPLACE WITH NEW 3" BITUMINOUS. (SEPARATE BIDS BY ADDRESS)
 - ALT BID 1 - DEMO DRIVEWAYS AND REPLACE WITH NEW 3" BITUMINOUS. (SEPARATE BIDS BY ADDRESS)
 - ALT BID 2 - DEMO DRIVEWAY AND REPLACE WITH NEW PAVEDRAIN, 6-INCHES OF 3/4"-1" CLEAN STONE ONLY. NO 2-3" STONE NECESSARY (SEPARATE BIDS BY ADDRESS)
 - ALL CONTRACTS TO BE COMPLETE BY DECEMBER OF 2018

NDS
 WE PUT WATER IN ITS PLACE

11111 12TH CHANNEL DRAIN
 RAIN GAUGE
 Monitor Point

11.4" x 12" W/ Channel Drain

last 4" - open concrete swale
 101" - 8" PVC drain embedded
 in 18" W/ x 14" L Concrete

3837 21ave S
 3841 21ave S
 3845 21ave S
 3849 21ave S
 3853 21ave S
 3857 21ave S
 3861 21ave S
 3865 21ave S
 3869 21ave S
 3873 21ave S
 3877 21ave S
 3881 21ave S
 3885 21ave S
 3889 21ave S
 3893 21ave S
 3897 21ave S
 3901 21ave S
 3905 21ave S
 3909 21ave S
 3913 21ave S
 3917 21ave S
 3921 21ave S
 3925 21ave S
 3929 21ave S
 3933 21ave S
 3937 21ave S
 3941 21ave S
 3945 21ave S
 3949 21ave S
 3953 21ave S
 3957 21ave S
 3961 21ave S
 3965 21ave S
 3969 21ave S
 3973 21ave S
 3977 21ave S
 3981 21ave S
 3985 21ave S
 3989 21ave S
 3993 21ave S
 3997 21ave S
 4001 21ave S
 4005 21ave S
 4009 21ave S
 4013 21ave S
 4017 21ave S
 4021 21ave S
 4025 21ave S
 4029 21ave S
 4033 21ave S
 4037 21ave S
 4041 21ave S
 4045 21ave S
 4049 21ave S
 4053 21ave S
 4057 21ave S
 4061 21ave S
 4065 21ave S
 4069 21ave S
 4073 21ave S
 4077 21ave S
 4081 21ave S
 4085 21ave S
 4089 21ave S
 4093 21ave S
 4097 21ave S
 4101 21ave S
 4105 21ave S
 4109 21ave S
 4113 21ave S
 4117 21ave S
 4121 21ave S
 4125 21ave S
 4129 21ave S
 4133 21ave S
 4137 21ave S
 4141 21ave S
 4145 21ave S
 4149 21ave S
 4153 21ave S
 4157 21ave S
 4161 21ave S
 4165 21ave S
 4169 21ave S
 4173 21ave S
 4177 21ave S
 4181 21ave S
 4185 21ave S
 4189 21ave S
 4193 21ave S
 4197 21ave S
 4201 21ave S
 4205 21ave S
 4209 21ave S
 4213 21ave S
 4217 21ave S
 4221 21ave S
 4225 21ave S
 4229 21ave S
 4233 21ave S
 4237 21ave S
 4241 21ave S
 4245 21ave S
 4249 21ave S
 4253 21ave S
 4257 21ave S
 4261 21ave S
 4265 21ave S
 4269 21ave S
 4273 21ave S
 4277 21ave S
 4281 21ave S
 4285 21ave S
 4289 21ave S
 4293 21ave S
 4297 21ave S
 4301 21ave S
 4305 21ave S
 4309 21ave S
 4313 21ave S
 4317 21ave S
 4321 21ave S
 4325 21ave S
 4329 21ave S
 4333 21ave S
 4337 21ave S
 4341 21ave S
 4345 21ave S
 4349 21ave S
 4353 21ave S
 4357 21ave S
 4361 21ave S
 4365 21ave S
 4369 21ave S
 4373 21ave S
 4377 21ave S
 4381 21ave S
 4385 21ave S
 4389 21ave S
 4393 21ave S
 4397 21ave S
 4401 21ave S
 4405 21ave S
 4409 21ave S
 4413 21ave S
 4417 21ave S
 4421 21ave S
 4425 21ave S
 4429 21ave S
 4433 21ave S
 4437 21ave S
 4441 21ave S
 4445 21ave S
 4449 21ave S
 4453 21ave S
 4457 21ave S
 4461 21ave S
 4465 21ave S
 4469 21ave S
 4473 21ave S
 4477 21ave S
 4481 21ave S
 4485 21ave S
 4489 21ave S
 4493 21ave S
 4497 21ave S
 4501 21ave S
 4505 21ave S
 4509 21ave S
 4513 21ave S
 4517 21ave S
 4521 21ave S
 4525 21ave S
 4529 21ave S
 4533 21ave S
 4537 21ave S
 4541 21ave S
 4545 21ave S
 4549 21ave S
 4553 21ave S
 4557 21ave S
 4561 21ave S
 4565 21ave S
 4569 21ave S
 4573 21ave S
 4577 21ave S
 4581 21ave S
 4585 21ave S
 4589 21ave S
 4593 21ave S
 4597 21ave S
 4601 21ave S
 4605 21ave S
 4609 21ave S
 4613 21ave S
 4617 21ave S
 4621 21ave S
 4625 21ave S
 4629 21ave S
 4633 21ave S
 4637 21ave S
 4641 21ave S
 4645 21ave S
 4649 21ave S
 4653 21ave S
 4657 21ave S
 4661 21ave S
 4665 21ave S
 4669 21ave S
 4673 21ave S
 4677 21ave S
 4681 21ave S
 4685 21ave S
 4689 21ave S
 4693 21ave S
 4697 21ave S
 4701 21ave S
 4705 21ave S
 4709 21ave S
 4713 21ave S
 4717 21ave S
 4721 21ave S
 4725 21ave S
 4729 21ave S
 4733 21ave S
 4737 21ave S
 4741 21ave S
 4745 21ave S
 4749 21ave S
 4753 21ave S
 4757 21ave S
 4761 21ave S
 4765 21ave S
 4769 21ave S
 4773 21ave S
 4777 21ave S
 4781 21ave S
 4785 21ave S
 4789 21ave S
 4793 21ave S
 4797 21ave S
 4801 21ave S
 4805 21ave S
 4809 21ave S
 4813 21ave S
 4817 21ave S
 4821 21ave S
 4825 21ave S
 4829 21ave S
 4833 21ave S
 4837 21ave S
 4841 21ave S
 4845 21ave S
 4849 21ave S
 4853 21ave S
 4857 21ave S
 4861 21ave S
 4865 21ave S
 4869 21ave S
 4873 21ave S
 4877 21ave S
 4881 21ave S
 4885 21ave S
 4889 21ave S
 4893 21ave S
 4897 21ave S
 4901 21ave S
 4905 21ave S
 4909 21ave S
 4913 21ave S
 4917 21ave S
 4921 21ave S
 4925 21ave S
 4929 21ave S
 4933 21ave S
 4937 21ave S
 4941 21ave S
 4945 21ave S
 4949 21ave S
 4953 21ave S
 4957 21ave S
 4961 21ave S
 4965 21ave S
 4969 21ave S
 4973 21ave S
 4977 21ave S
 4981 21ave S
 4985 21ave S
 4989 21ave S
 4993 21ave S
 4997 21ave S
 5001 21ave S
 5005 21ave S
 5009 21ave S
 5013 21ave S
 5017 21ave S
 5021 21ave S
 5025 21ave S
 5029 21ave S
 5033 21ave S
 5037 21ave S
 5041 21ave S
 5045 21ave S
 5049 21ave S
 5053 21ave S
 5057 21ave S
 5061 21ave S
 5065 21ave S
 5069 21ave S
 5073 21ave S
 5077 21ave S
 5081 21ave S
 5085 21ave S
 5089 21ave S
 5093 21ave S
 5097 21ave S
 5101 21ave S
 5105 21ave S
 5109 21ave S
 5113 21ave S
 5117 21ave S
 5121 21ave S
 5125 21ave S
 5129 21ave S
 5133 21ave S
 5137 21ave S
 5141 21ave S
 5145 21ave S
 5149 21ave S
 5153 21ave S
 5157 21ave S
 5161 21ave S
 5165 21ave S
 5169 21ave S
 5173 21ave S
 5177 21ave S
 5181 21ave S
 5185 21ave S
 5189 21ave S
 5193 21ave S
 5197 21ave S
 5201 21ave S
 5205 21ave S
 5209 21ave S
 5213 21ave S
 5217 21ave S
 5221 21ave S
 5225 21ave S
 5229 21ave S
 5233 21ave S
 5237 21ave S
 5241 21ave S
 5245 21ave S
 5249 21ave S
 5253 21ave S
 5257 21ave S
 5261 21ave S
 5265 21ave S
 5269 21ave S
 5273 21ave S
 5277 21ave S
 5281 21ave S
 5285 21ave S
 5289 21ave S
 5293 21ave S
 5297 21ave S
 5301 21ave S
 5305 21ave S
 5309 21ave S
 5313 21ave S
 5317 21ave S
 5321 21ave S
 5325 21ave S
 5329 21ave S
 5333 21ave S
 5337 21ave S
 5341 21ave S
 5345 21ave S
 5349 21ave S
 5353 21ave S
 5357 21ave S
 5361 21ave S
 5365 21ave S
 5369 21ave S
 5373 21ave S
 5377 21ave S
 5381 21ave S
 5385 21ave S
 5389 21ave S
 5393 21ave S
 5397 21ave S
 5401 21ave S
 5405 21ave S
 5409 21ave S
 5413 21ave S
 5417 21ave S
 5421 21ave S
 5425 21ave S
 5429 21ave S
 5433 21ave S
 5437 21ave S
 5441 21ave S
 5445 21ave S
 5449 21ave S
 5453 21ave S
 5457 21ave S
 5461 21ave S
 5465 21ave S
 5469 21ave S
 5473 21ave S
 5477 21ave S
 5481 21ave S
 5485 21ave S
 5489 21ave S
 5493 21ave S
 5497 21ave S
 5501 21ave S
 5505 21ave S
 5509 21ave S
 5513 21ave S
 5517 21ave S
 5521 21ave S
 5525 21ave S
 5529 21ave S
 5533 21ave S
 5537 21ave S
 5541 21ave S
 5545 21ave S
 5549 21ave S
 5553 21ave S
 5557 21ave S
 5561 21ave S
 5565 21ave S
 5569 21ave S
 5573 21ave S
 5577 21ave S
 5581 21ave S
 5585 21ave S
 5589 21ave S
 5593 21ave S
 5597 21ave S
 5601 21ave S
 5605 21ave S
 5609 21ave S
 5613 21ave S
 5617 21ave S
 5621 21ave S
 5625 21ave S
 5629 21ave S
 5633 21ave S
 5637 21ave S
 5641 21ave S
 5645 21ave S
 5649 21ave S
 5653 21ave S
 5657 21ave S
 5661 21ave S
 5665 21ave S
 5669 21ave S
 5673 21ave S
 5677 21ave S
 5681 21ave S
 5685 21ave S
 5689 21ave S
 5693 21ave S
 5697 21ave S
 5701 21ave S
 5705 21ave S
 5709 21ave S
 5713 21ave S
 5717 21ave S
 5721 21ave S
 5725 21ave S
 5729 21ave S
 5733 21ave S
 5737 21ave S
 5741 21ave S
 5745 21ave S
 5749 21ave S
 5753 21ave S
 5757 21ave S
 5761 21ave S
 5765 21ave S
 5769 21ave S
 5773 21ave S
 5777 21ave S
 5781 21ave S
 5785 21ave S
 5789 21ave S
 5793 21ave S
 5797 21ave S
 5801 21ave S
 5805 21ave S
 5809 21ave S
 5813 21ave S
 5817 21ave S
 5821 21ave S
 5825 21ave S
 5829 21ave S
 5833 21ave S
 5837 21ave S
 5841 21ave S
 5845 21ave S
 5849 21ave S
 5853 21ave S
 5857 21ave S
 5861 21ave S
 5865 21ave S
 5869 21ave S
 5873 21ave S
 5877 21ave S
 5881 21ave S
 5885 21ave S
 5889 21ave S
 5893 21ave S
 5897 21ave S
 5901 21ave S
 5905 21ave S
 5909 21ave S
 5913 21ave S
 5917 21ave S
 5921 21ave S
 5925 21ave S
 5929 21ave S
 5933 21ave S
 5937 21ave S
 5941 21ave S
 5945 21ave S
 5949 21ave S
 5953 21ave S
 5957 21ave S
 5961 21ave S
 5965 21ave S
 5969 21ave S
 5973 21ave S
 5977 21ave S
 5981 21ave S
 5985 21ave S
 5989 21ave S
 5993 21ave S
 5997 21ave S
 6001 21ave S
 6005 21ave S
 6009 21ave S
 6013 21ave S
 6017 21ave S
 6021 21ave S
 6025 21ave S
 6029 21ave S
 6033 21ave S
 6037 21ave S
 6041 21ave S
 6045 21ave S
 6049 21ave S
 6053 21ave S
 6057 21ave S
 6061 21ave S
 6065 21ave S
 6069 21ave S
 6073 21ave S
 6077 21ave S
 6081 21ave S
 6085 21ave S
 6089 21ave S
 6093 21ave S
 6097 21ave S
 6101 21ave S
 6105 21ave S
 6109 21ave S
 6113 21ave S
 6117 21ave S
 6121 21ave S
 6125 21ave S
 6129 21ave S
 6133 21ave S
 6137 21ave S
 6141 21ave S
 6145 21ave S
 6149 21ave S
 6153 21ave S
 6157 21ave S
 6161 21ave S
 6165 21ave S
 6169 21ave S
 6173 21ave S
 6177 21ave S
 6181 21ave S
 6185 21ave S
 6189 21ave S
 6193 21ave S
 6197 21ave S
 6201 21ave S
 6205 21ave S
 6209 21ave S
 6213 21ave S
 6217 21ave S
 6221 21ave S
 6225 21ave S
 6229 21ave S
 6233 21ave S
 6237 21ave S
 6241 21ave S
 6245 21ave S
 6249 21ave S
 6253 21ave S
 6257 21ave S
 6261 21ave S
 6265 21ave S
 6269 21ave S
 6273 21ave S
 6277 21ave S
 6281 21ave S
 6285 21ave S
 6289 21ave S
 6293 21ave S
 6297 21ave S
 6301 21ave S
 6305 21ave S
 6309 21ave S
 6313 21ave S
 6317 21ave S
 6321 21ave S
 6325 21ave S
 6329 21ave S
 6333 21ave S
 6337 21ave S
 6341 21ave S
 6345 21ave S
 6349 21ave S
 6353 21ave S
 6357 21ave S
 6361 21ave S
 6365 21ave S
 6369 21ave S
 6373 21ave S
 6377 21ave S
 6381 21ave S
 6385 21ave S
 6389 21ave S
 6393 21ave S
 6397 21ave S
 6401 21ave S
 6405 21ave S
 6409 21ave S
 6413 21ave S
 6417 21ave S
 6421 21ave S
 6425 21ave S
 6429 21ave S
 6433 21ave S
 6437 21ave S
 6441 21ave S
 6445 21ave S
 6449 21ave S
 6453 21ave S
 6457 21ave S
 6461 21ave S
 6465 21ave S
 6469 21ave S
 6473 21ave S
 6477 21ave S
 6481 21ave S
 6485 21ave S
 6489 21ave S
 6493 21ave S
 6497 21ave S
 6501 21ave S
 6505 21ave S
 6509 21ave S
 6513 21ave S
 6517 21ave S
 6521 21ave S
 6525 21ave S
 6529 21ave S
 6533 21ave S
 6537 21ave S
 6541 21ave S
 6545 21ave S
 6549 21ave S
 6553 21ave S
 6557 21ave S
 6561 21ave S
 6565 21ave S
 6569 21ave S
 6573 21ave S
 6577 21ave S
 6581 21ave S
 6585 21ave S
 6589 21ave S
 6593 21ave S
 6597 21ave S
 6601 21ave S
 6605 21ave S
 6609 21ave S
 6613 21ave S
 6617 21ave S
 6621 21ave S
 6625 21ave S
 6629 21ave S
 6633 21ave S
 6637 21ave S
 6641 21ave S
 6645 21ave S
 6649 21ave S
 6653 21ave S
 6657 21ave S
 6661 21ave S
 6665 21ave S
 6669 21ave S
 6673 21ave S
 6677 21ave S
 6681 21ave S
 6685 21ave S
 6689 21ave S
 6693 21ave S
 6697 21ave S
 6701 21ave S
 6705 21ave S
 6709 21ave S
 6713 21ave S
 6717 21ave S
 6721 21ave S
 6725 21ave S
 6729 21ave S
 6733 21ave S
 6737 21ave S
 6741 21ave S
 6745 21ave S
 6749 21ave S
 6753 21ave S
 6757 21ave S
 6761 21ave S
 6765 21ave S
 6769 21ave S
 6773 21ave S
 6777 21ave S
 6781 21ave S
 6785 21ave S
 6789 21ave S
 6793 21ave S
 6797 21ave S
 6801 21ave S
 6805 21ave S
 6809 21ave S
 6813 21ave S
 6817 21ave S
 6821 21ave S
 6825 21ave S
 6829 21ave S
 6833 21ave S
 6837 21ave S
 6841 21ave S
 6845 21ave S
 6849 21ave S
 6853 21ave S
 6857 21ave S
 6861 21ave S
 6865 21ave S
 6869 21ave S
 6873 21ave S
 6877 21ave S
 6881 21ave S
 6885 21ave S
 6889 21ave S
 6893 21ave S
 6897 21ave S
 6901 21ave S
 6905 21ave S
 6909 21ave S
 6913 21ave S
 6917 21ave S
 6921 21ave S
 6925 21ave S
 6929 21ave S
 6933 21ave S
 6937 21ave S
 6941 21ave S
 6945 21ave S
 6949 21ave S
 6953 21ave S

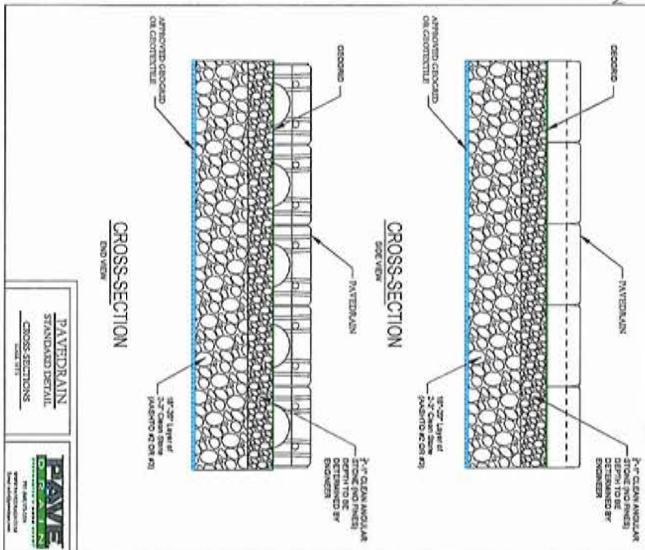
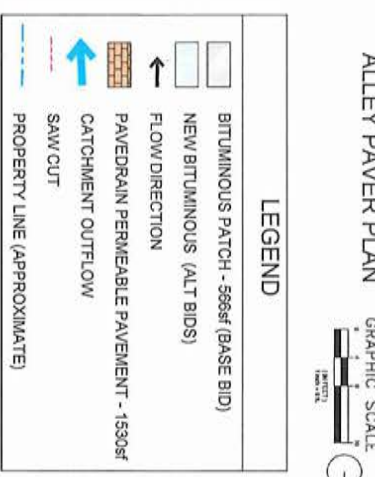
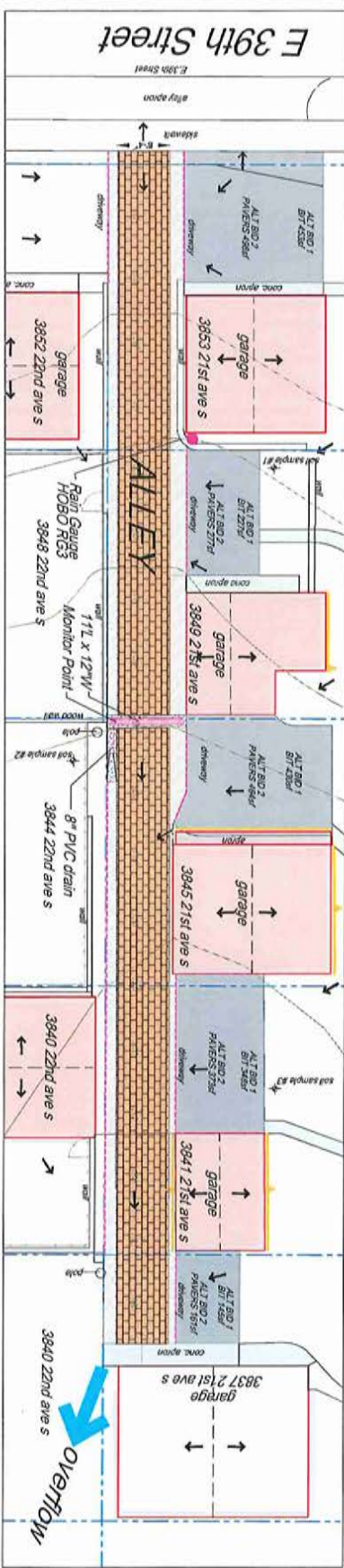
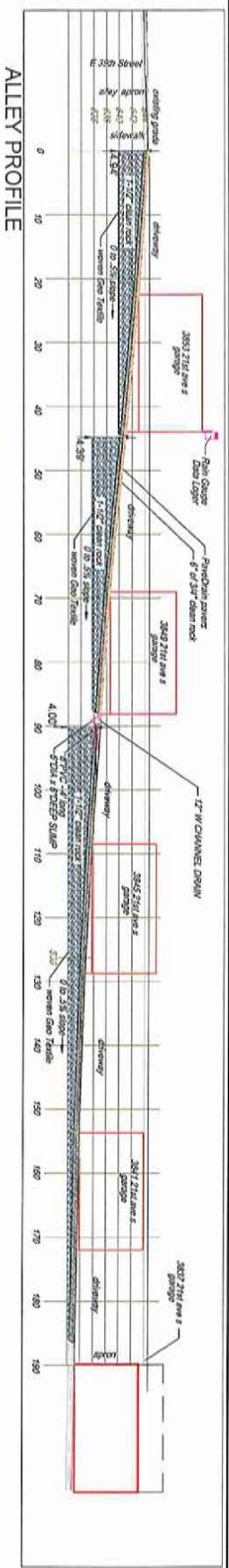

NOTES:
 AREAS, LOCATIONS OF STRUCTURES AND SURFACE FEATURES ARE APPROXIMATE AS DETERMINED FROM AERIAL PHOTOGRAPHS, SITE PHOTOGRAPHS AND FIELD MEASUREMENTS.
 CONTRACTOR RESPONSIBLE FOR LOCATING PROPERTY LINES AND UTILITIES.

BID NOTES:
 CONTRACTORS TO PROVIDE BIDS FOR THE FOLLOWING:

1. TRENCH DRAIN, DRAIN SYSTEM, RAIN GAUGE (ONSET HOBO RG3) AND MONITOR HARDWARE AS DETAILED BELOW (INSTALL IN APRIL OF 2017)
2. BASE BID AND/OR ALT BIDS (INSTALL APRIL OF 2018)
- 2.1. BASE BID - DEMOLITION OF ALLEY (REMOVAL OF EXISTING BITUMINOUS SURFACE AND ALL SUB SURFACE MATERIAL TO ALLOW FOR THE INSTALLATION OF A NEW PERMEABLE PAVEMENT PAVEDRAIN SYSTEM.
- 2.1. BASE BID - INSTALLATION OF A PAVEDRAIN SYSTEM AS DETAILED ON SHEET L2 (HAND METHOD), TO INCLUDE BITUMINOUS PATCH TO SAW CUT.
3. ALT BID 1 - DEMO DRIVEWAYS AND REPLACE WITH NEW 3\"/>
4. ALT BID 2 - DEMO DRIVEWAY AND REPLACE WITH NEW PAVEDRAIN, 6-INCHES OF 3/4\"/>
5. ALL CONTRACTS TO BE COMPLETE BY DECEMBER OF 2018



Metro Blooms
 PO Box 17098
 Minneapolis, MN 55417
 651-896-2426

Standish Ericsson
 Alley Project

NO.	DATE	DESCRIPTION
1	08/01/17	ISSUED FOR BIDDING
2	08/01/17	ISSUED FOR BIDDING
3	08/01/17	ISSUED FOR BIDDING
4	08/01/17	ISSUED FOR BIDDING
5	08/01/17	ISSUED FOR BIDDING
6	08/01/17	ISSUED FOR BIDDING
7	08/01/17	ISSUED FOR BIDDING
8	08/01/17	ISSUED FOR BIDDING
9	08/01/17	ISSUED FOR BIDDING
10	08/01/17	ISSUED FOR BIDDING
11	08/01/17	ISSUED FOR BIDDING
12	08/01/17	ISSUED FOR BIDDING
13	08/01/17	ISSUED FOR BIDDING
14	08/01/17	ISSUED FOR BIDDING
15	08/01/17	ISSUED FOR BIDDING
16	08/01/17	ISSUED FOR BIDDING
17	08/01/17	ISSUED FOR BIDDING
18	08/01/17	ISSUED FOR BIDDING
19	08/01/17	ISSUED FOR BIDDING
20	08/01/17	ISSUED FOR BIDDING
21	08/01/17	ISSUED FOR BIDDING
22	08/01/17	ISSUED FOR BIDDING
23	08/01/17	ISSUED FOR BIDDING
24	08/01/17	ISSUED FOR BIDDING
25	08/01/17	ISSUED FOR BIDDING
26	08/01/17	ISSUED FOR BIDDING
27	08/01/17	ISSUED FOR BIDDING
28	08/01/17	ISSUED FOR BIDDING
29	08/01/17	ISSUED FOR BIDDING
30	08/01/17	ISSUED FOR BIDDING
31	08/01/17	ISSUED FOR BIDDING
32	08/01/17	ISSUED FOR BIDDING
33	08/01/17	ISSUED FOR BIDDING
34	08/01/17	ISSUED FOR BIDDING
35	08/01/17	ISSUED FOR BIDDING
36	08/01/17	ISSUED FOR BIDDING
37	08/01/17	ISSUED FOR BIDDING
38	08/01/17	ISSUED FOR BIDDING
39	08/01/17	ISSUED FOR BIDDING
40	08/01/17	ISSUED FOR BIDDING
41	08/01/17	ISSUED FOR BIDDING
42	08/01/17	ISSUED FOR BIDDING
43	08/01/17	ISSUED FOR BIDDING
44	08/01/17	ISSUED FOR BIDDING
45	08/01/17	ISSUED FOR BIDDING
46	08/01/17	ISSUED FOR BIDDING
47	08/01/17	ISSUED FOR BIDDING
48	08/01/17	ISSUED FOR BIDDING
49	08/01/17	ISSUED FOR BIDDING
50	08/01/17	ISSUED FOR BIDDING

L2

