

MEETING DATE: November 8, 2018

TITLE: Authorization to Enter Contract for Installation of Electricity for Six Mile Creek-Halsted Bay Aeration

RES. NUMBER: 18-116

PREPARED BY: Anna Brown

E-MAIL: abrown@minnehahacreek.org

TELEPHONE: 952-641-4522

REVIEWED BY: Administrator Counsel Program Mgr.: Michael Hayman
 Board Committee Engineer Other

WORKSHOP ACTION:

<input type="checkbox"/> Advance to Board mtg. Consent Agenda.	<input type="checkbox"/> Advance to Board meeting for discussion prior to action.
<input type="checkbox"/> Refer to a future workshop (date):_____	<input type="checkbox"/> Refer to taskforce or committee (date):_____
<input type="checkbox"/> Return to staff for additional work.	<input type="checkbox"/> No further action requested.
<input checked="" type="checkbox"/> Other (specify): <u>Final approval November 8, 2018</u>	

PURPOSE or ACTION REQUESTED:

Authorization to execute a contract with Telcom Construction, Inc. for installation of electric service to facilitate aeration for the Six Mile Creek-Halsted Bay (SMCHB) Habitat Restoration program.

PROJECT/PROGRAM LOCATION:

Six Mile Creek-Halsted Bay Subwatershed

PROJECT TIMELINE:

Nov/Dec 2018 – Installation of utility services

PROJECT/PROGRAM COST:

Fund name and number: SMCHB – Carp Management (500-5007)

Current Budget: \$567,000.00

Expenditures to date: \$54,000.00

Requested amount of funding: \$61,877.00 (\$56,251.00 + 10% contingency) for installation

\$16,680.00 (\$13,900.00 + 20% contingency) for service fees

PAST BOARD ACTION:

March 27, 2014 – Authorization to enter into contract for the SMCHB carp assessment (14-025)

May 11, 2017 – Authorization to request funding from Lessard Sams Outdoor Heritage Council (17-036)

July 26, 2018 – Authorization to execute contract for utility design and coordination (18-070)

SUMMARY:

In September 2017 the Lessard Sams Outdoor Heritage Council (LSOHC) recommended the Six Mile Creek-Halsted Bay (SMCHB) Habitat Restoration Project for \$567,000 to the Minnesota State Legislature. The funding bill was approved by the legislature and the grant period began on July 1, 2018. The program takes a holistic and comprehensive approach to managing common carp in the SMCHB Subwatershed based on the University of Minnesota's SMCHB carp assessment (2014-2017), consisting primarily of three management strategies:

- Adult biomass removal
- Aeration of shallow lakes to prevent successful carp reproduction
- Barriers to prevent carp movement between waterbodies and assist with removal

Consistent with the accomplishment plan approved by LSOHC, the grant funds will be used to pay for the capital cost of barrier installation, utility installation for aeration, and the fish removal contracts. The District match includes equipment for removal and monitoring, the aeration units, and design services.

Utility Service Need

Shallow lake aeration is a management strategy that targets lakes identified as known or likely reproduction areas. The carp assessment identified six lakes across SMCHB that are likely recruitment areas – Turbid, Marsh, Sunny, North and South Lundsten, and Mud lakes.

In July 2018, the MCWD Board awarded a contract to Telcom Construction for utility design and coordination to extend electric service to these sites to facilitate aeration. The utility design plan set is attached. Telcom is recommending that the District move forward with the installation of utility services at Turbid, Marsh, South Lundsten, and Mud Lakes. For North Lundsten, Telcom is recommending we postpone installation until next summer or fall, as current winter charges in place will drive the cost of that installation significantly higher than projected. For Sunny Lake, staff have found that a barrier is a more cost effective solution than aeration and is working with LSOHC staff to amend the program budget to accommodate an additional barrier.

The quote provided by Telcom for the four sites they recommend installing this year is as follows:

Site	Cost
Mud Lake	\$14,704.50
South Lundsten	\$16,228.75
Marsh Lake	\$12,097.50
Turbid Lake	\$13,221.00

In addition to the contract costs with Telcom, Minnesota Valley Electric Coop and Xcel Energy require fees for new service extensions. The cost of these fees is an estimated \$13,900.00 and is grant eligible.

Land Rights

Associated land rights for the installation of utilities at Mud Lake and South Lundsten are secured. On Mud Lake, the District has an existing conservation easement and has been working with the landowner to vet the final configuration. On South Lundsten, MCWD is requesting authorization to enter an agreement with Three Rivers Park District to provide for aeration at the November 8, 2018 Board Meeting.

Land rights for the utility service installation are still under development for Turbid and Marsh lakes. Staff are recommending we proceed with awarding the contract for these service locations at this time so that the right-of-way permitting process can commence. However, if land rights are not secured for construction, these sites will be postponed until 2019.

Recommendation

Because this contract is a service contract for the delivery of electricity to which the installation of equipment is incidental to that service delivery, competitive procurement requirements under Minnesota Statute 471.345 do not apply. Further, Telcom is uniquely qualified to provide this service given its familiarity with the sites and the groundwork that has been advanced with the utility companies and landowners. Finally, there is an urgency to install the utilities before winter so that the District can be prepared to deploy the aeration units.

Therefore, staff are recommending that the Board of Managers award the contract for utility service installation to Telcom Construction.

Attachments

- Preliminary design plans
 - Telcom utility installation quote
 - Telcom utility fee estimate
-

RESOLUTION

RESOLUTION NUMBER: 18-116

TITLE: Authorization to enter contract for installation of electricity for Six Mile Creek-Halsted Bay aeration

WHEREAS, pursuant to Resolution 14-047 the MCWD Board of Managers has identified the Six Mile Creek-Halsted Bay (SMCHB) Subwatershed as a priority area for focusing District planning activities and coordination efforts with subwatershed partners; and

WHEREAS, beginning in 2016, MCWD led in the development of a comprehensive restoration strategy for the SMCHB subwatershed to achieve the District's goals of protecting and improving water quality, water quantity, ecological integrity, and thriving communities through land use and water integration, and includes rough fish management as a principal strategy for restoration;

WHEREAS, in September 2017, the Lessard Sams Outdoor Heritage Council recommended the SMCHB Habitat Restoration project for \$567,000 in funding, and the funding was approved by the MN Legislature in May 2018;

WHEREAS, In July 2018, staff solicited competitive quotes for utility coordination and design for aeration unit service installation and, pursuant to resolution 18-070, the MCWD Board of Managers awarded a contract to Telcom Construction, Inc. for those services;

WHEREAS, Telcom Construction, Inc. has completed its utility coordination and design work, and is recommending that the District proceed with service extension for Mud, South Lundsten, Marsh, and Turbid lakes;

WHEREAS, the extension of electricity to these sites is principally a service contract and therefore not subject to competitive procurement requirements under Minnesota Statute 471.345 and, further, Telcom Construction is uniquely qualified to provide this service given their familiarity with the project and ability to deliver these services in a timely manner;

NOW, THEREFORE, BE IT RESOLVED that the Minnehaha Creek Watershed District Board of Managers authorizes the District Administrator to execute a contract for utility installation in the Six Mile Creek-Halsted Bay subwatershed with Telcom Construction, Inc. in the amount of \$56,252.75;

BE IT FURTHER RESOLVED that the MCWD Board of Managers establishes a utility installation budget in the not-to-exceed amount of \$61,877.00 and authorizes the Administrator, in his judgment, to authorize change orders obligating the District up to that amount; and

BE IT FINALLY RESOLVED that the MCWD Board of Managers authorizes the Administrator to pay the associated fees for utility installation to Minnesota Valley Electric Coop and Xcel Energy, for an estimated cost of \$13,900, and establishes a not to exceed budget of \$16,680.

Resolution Number 18-116 was moved by Manager _____, seconded by Manager _____.
Motion to adopt the resolution ___ ayes, ___ nays, ___ abstentions. Date: _____.

Secretary

Date: _____

MINNEHAHA CREEK WATERSHED DISTRICT

SMCHB 6 Mile Habitat Restoration and Aeration

Installation Electric Motor Controller and Aspirators

Resource ListCorp

Anna Brown – Planner-Project Manager
 Minnehaha Creek Watershed District
 15320 Minnetonka Boulevard
 Minnetonka, MN 55345

Wayne Bauernschmitt: Site Consultant
 Telcom Construction Inc
 2218 200th Street E.
 Clearwater, MN 55320

Utility Contact

Xcel Energy
 Timothy Johnson
 Phone: 612-644-3238
 Email: Timothy.j.johnson@xcelenergy.com

Minnesota Valley Electric Coop
 Eric Kes / Bob Fenner
 Phone: 612.247.2419
 Email: erick@mvec.net

Note: The existing utility information shown on this plan
 Has been provided by the utility owner. The contractor
 Shall field verify exact location prior to commencing
 construction as required by state law.
 Notify Gopher State One Call, 1-800-252-1166

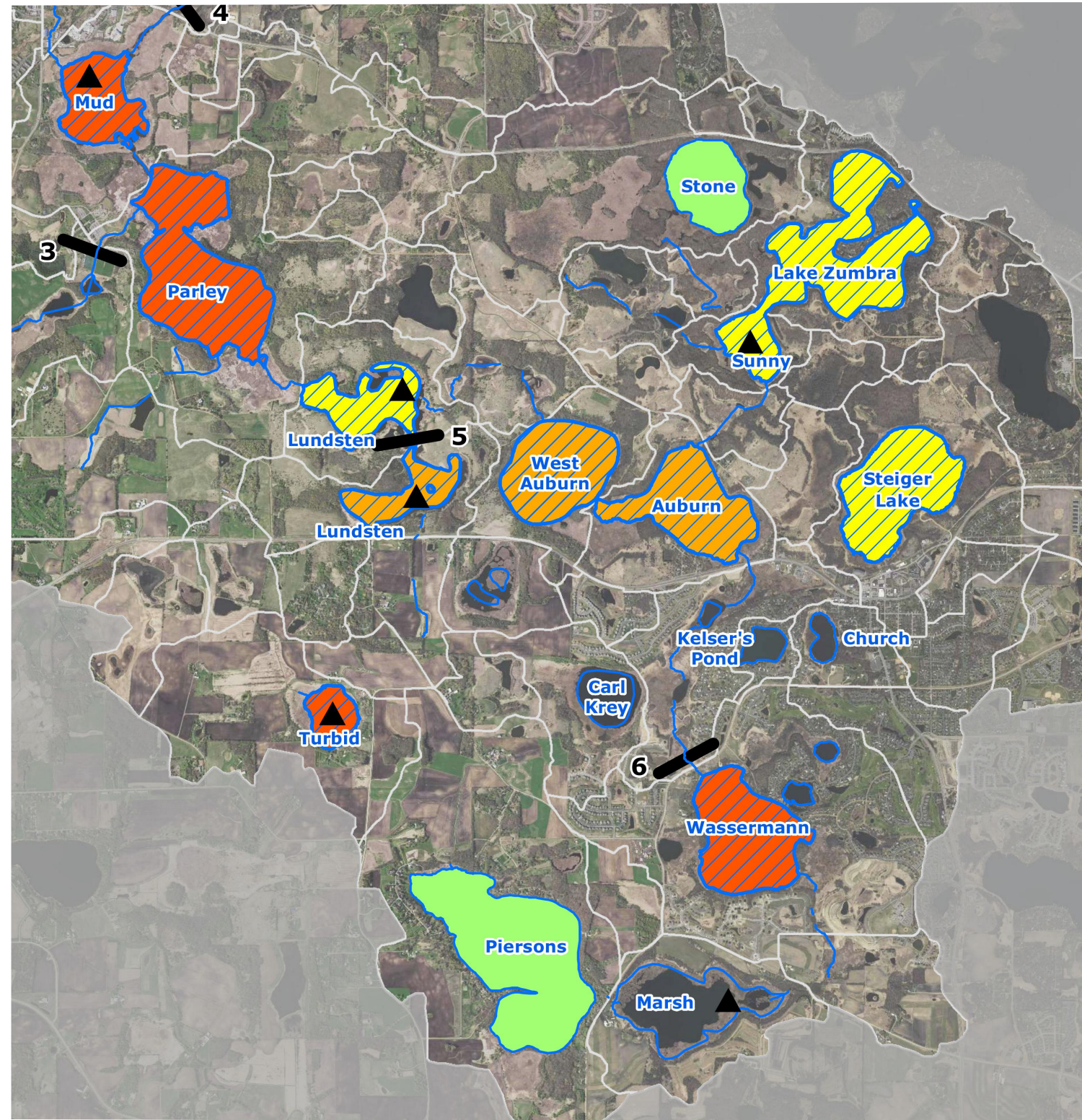

	FENCE LINE
	GUARD RAIL
	ACCESS CONTROL LINE
	CENTERLINE
	PROPERTY / LOT LINE
	ROAD RIGHT-OF-WAY LINE
	RAILROAD RIGHT-OF-WAY LINE
	GRAVEL EDGE
	BITUMINOUS EDGE
	CONCRETE EDGE
	CURB & GUTTER
	WATER EDGE
	WATER CENTERLINE
	HIGHWATER LINE
	WETLAND EDGE
	SWALE CENTERLINE
	RAILROAD TRACKS
	TREE DRIP LINE
	OVERHEAD ELECTRIC LINE
	UNDERGROUND ELECTRIC LINE
	GAS LINE
	FIBER OPTIC LINE
	UNDERGROUND COMMUNICATIONS LINE
	OVERHEAD UTILITY LINE
	WATER SYSTEM
	STORM SEWER
	TILE LINE
	SANITARY SEWER
	SANITARY FORCEMAIN
	CULVERT
	INTERMEDIATE CONTOURS
	INDEX CONTOURS
	COUNTY LINE
	CITY LIMITS
	SIXTEENTH LINE
	QUARTER LINE
	SECTION LINE
	ADJACENT LINES



CONTACT PERSON: WAYNE BAUERNSCHMITT
 OFFICE: 320-558-9485
 CELL: 320-428-2481
 EMAIL: WAYNE.BAUERNSCHMITT@TELCOMCONSTRUCTION.COM

PREFERRED INSTALLATION

Electrical Specs:

F&I the following:

- 120/240v 1ph 100A service
- Midwest Meter/Panel R101CB2
- wood post structure to mount electrical equipment on
- 2- 240v 30A GFCI protected circuits for aerators
- 2- motor starters in a weatherproof enclosure(hinged cover) , with 2 On/ Off selector switches, control circuitry
- Motor starters to have manual reset, no replaceable OL's
- 2- 30A Pin and Sleeve receptacles, with back boxes. HBL330R6W, BB301W
- 2- 8/3 SOOW cord sets w/ Pin & Sleeve plug, and connector. Length of cord TBD
- Strain relief plug and connector wire mesh grip-for cords on the service structure, and on the aerators
- 120v 20A Service GFCI Receptacle

Y Start - Delta Run
High Voltage

	Start	Run
<u>M1</u>	Close	Close
<u>M2</u>	Open	Close
<u>S</u>	Close	Open

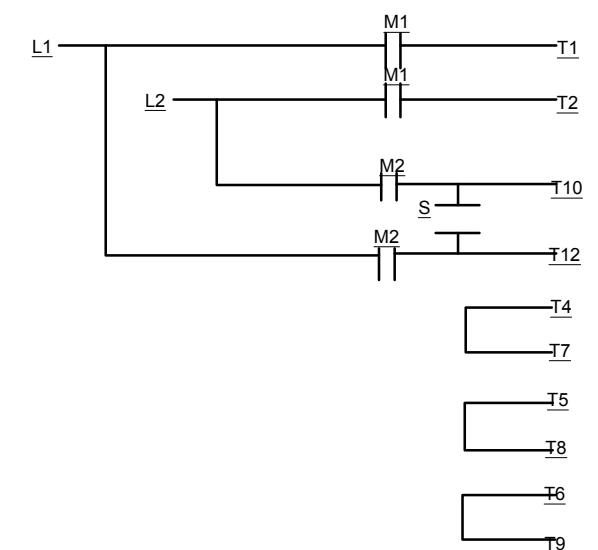

weatherproof enclosure
hinged cover
2-on/off selector Sw's
2-motor starters

Point of delivery at line side of meter on **residential service.** (see note 2)

The address shall be plainly marked by a permanent, durable means per Section 4.14.3 and 4.14.4 or 4.14.5

2-30A 250V 3 Wire Pin & Sleeve Recepticels

Midwest R101CB2 METER /Panel

6' Maximum
4' Minimum

Hoffman weathertight enclosure

Ground rod(s) furnished and installed by customer per *NEC.*

Minimum $\frac{3}{4}$ " exterior plywood suitability finished for weather resistance or suitable Unistrut

FINAL GRADE

36"

2- 6" X 6" treated wood posts or 2-4" GRC posts



CONTACT PERSON: WAYNE BAUERNSCHMITT
OFFICE: 320-558-9485
CELL: 320-428-2481
EMAIL: WAYNE.BAUERNSCHMITT@TELCOMCONSTRUCTION.COM

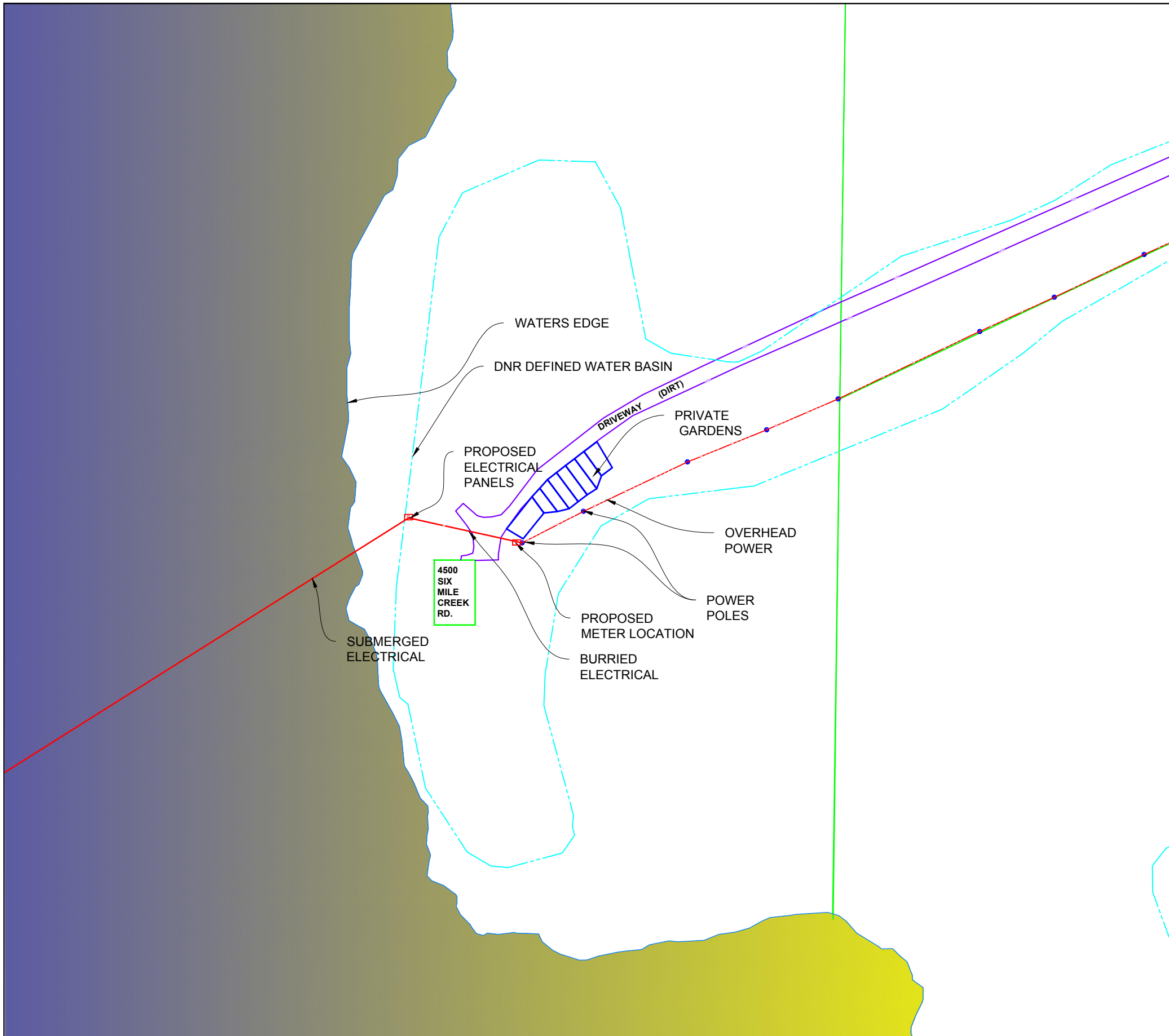

PREFERRED INSTALLATION

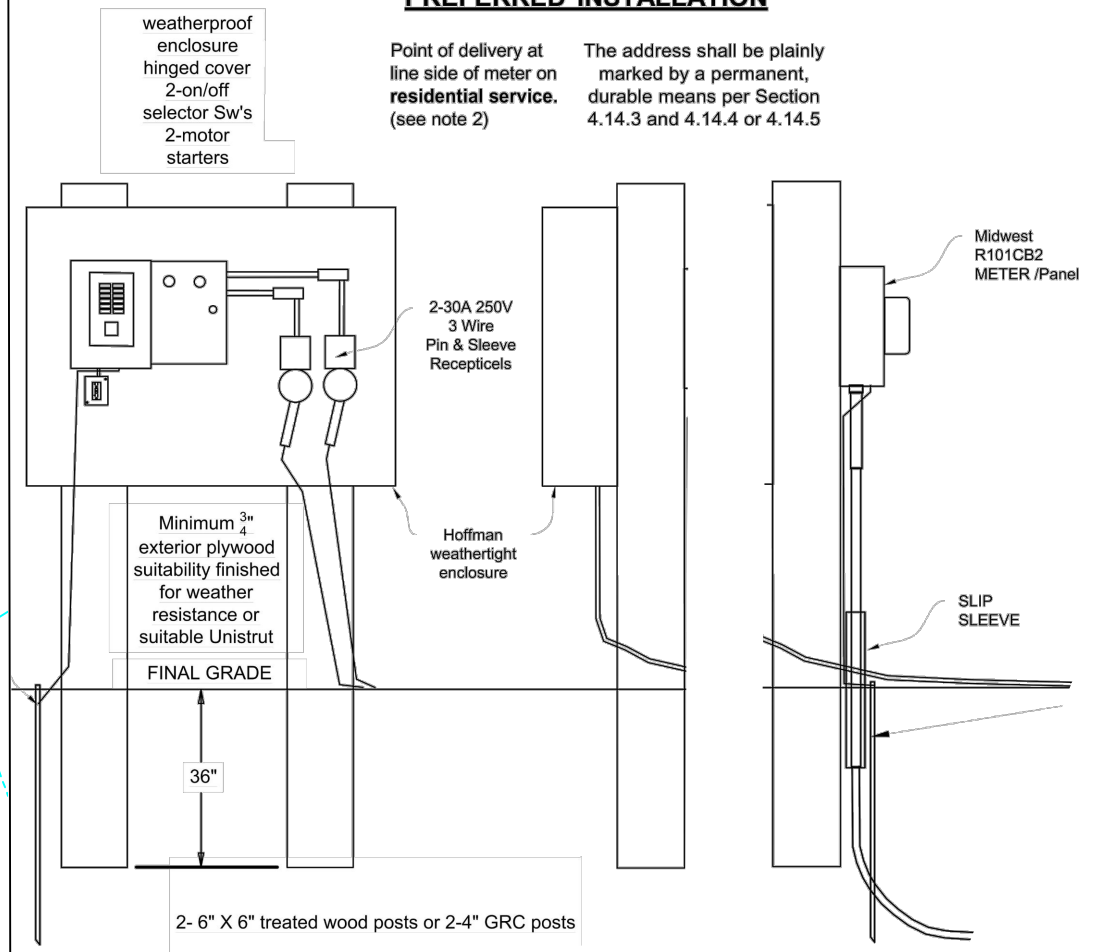

CONTACT PERSON: WAYNE BAUERNSCHMITT
 OFFICE: 320-558-9485
 CELL: 320-428-2481
 EMAIL: WAYNE.BAUERNSCHMITT@TELCOMCONSTRUCTION.COM

JOB: MUD LAKE

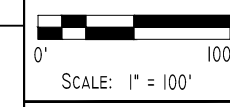

SHEET #: 4 OF 12

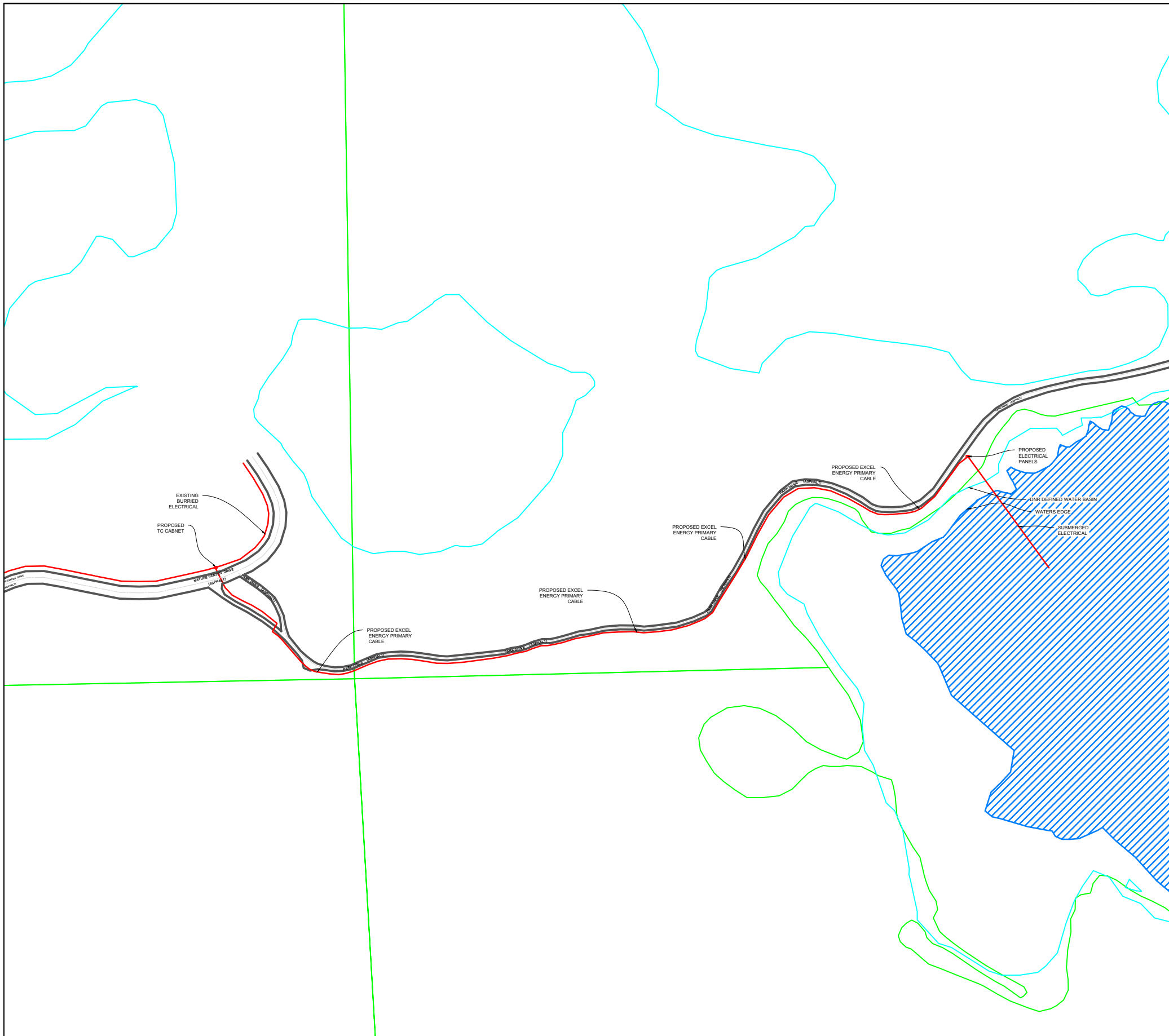

PREFERRED INSTALLATION

Point of delivery at line side of meter on residential service. (see note 2)

The address shall be plainly marked by a permanent, durable means per Section 4.14.3 and 4.14.4 or 4.14.5

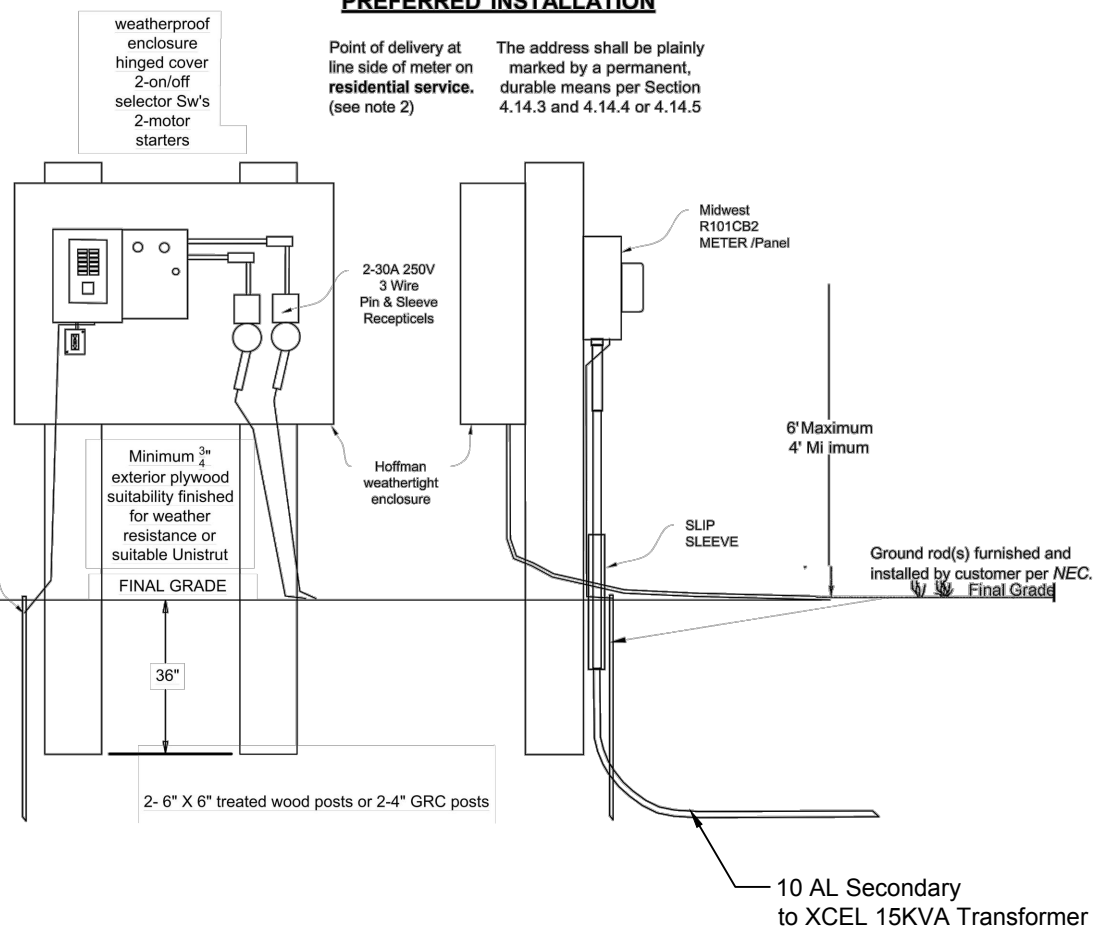

CONTACT PERSON: WAYNE BAUERNSCHMITT
 OFFICE: 320-558-9485
 CELL: 320-428-2481
 EMAIL: WAYNE.BAUERNSCHMITT@TELCOMCONSTRUCTION.COM

JOB: SUNNY LAKE

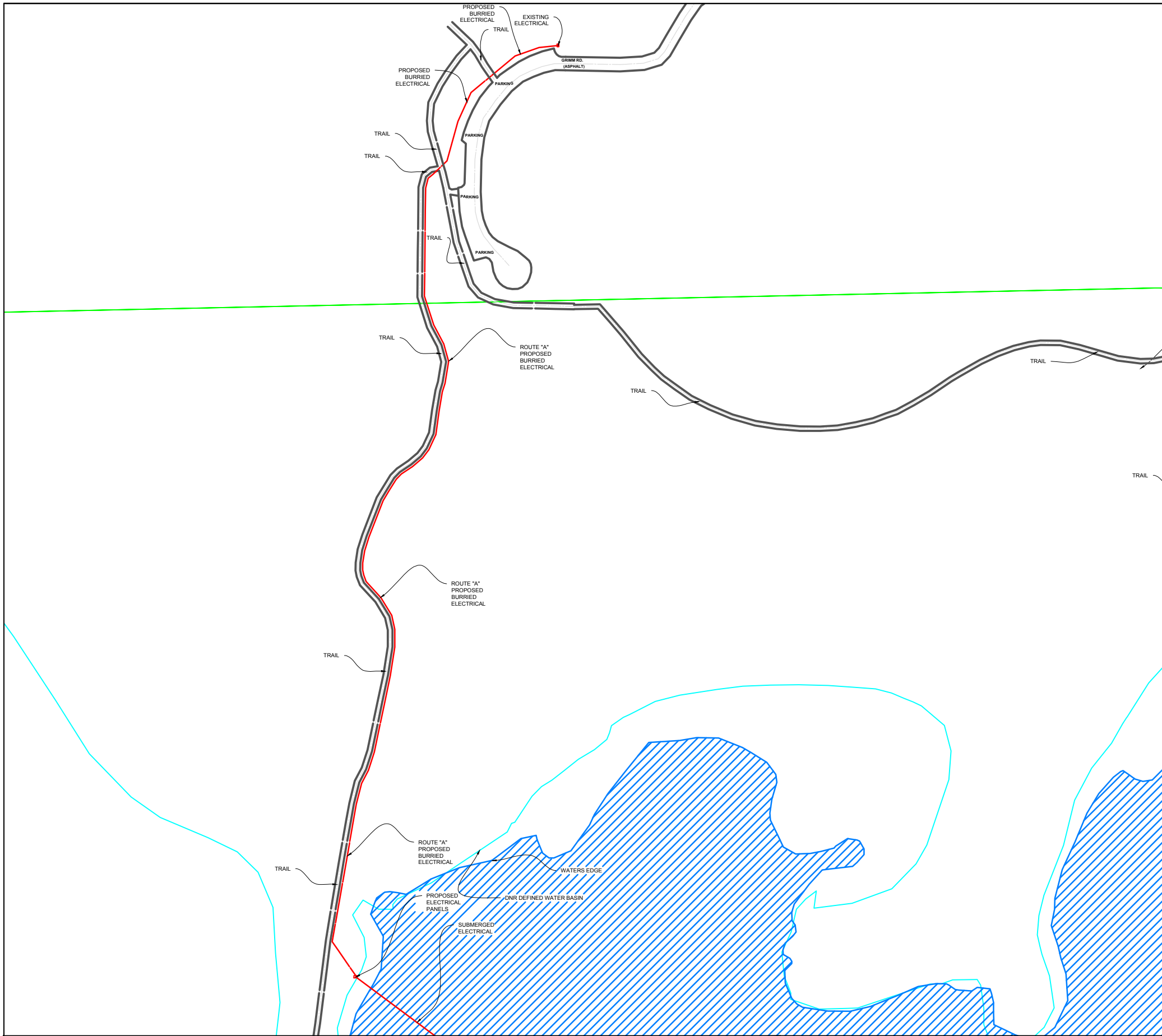

PREFERRED INSTALLATION

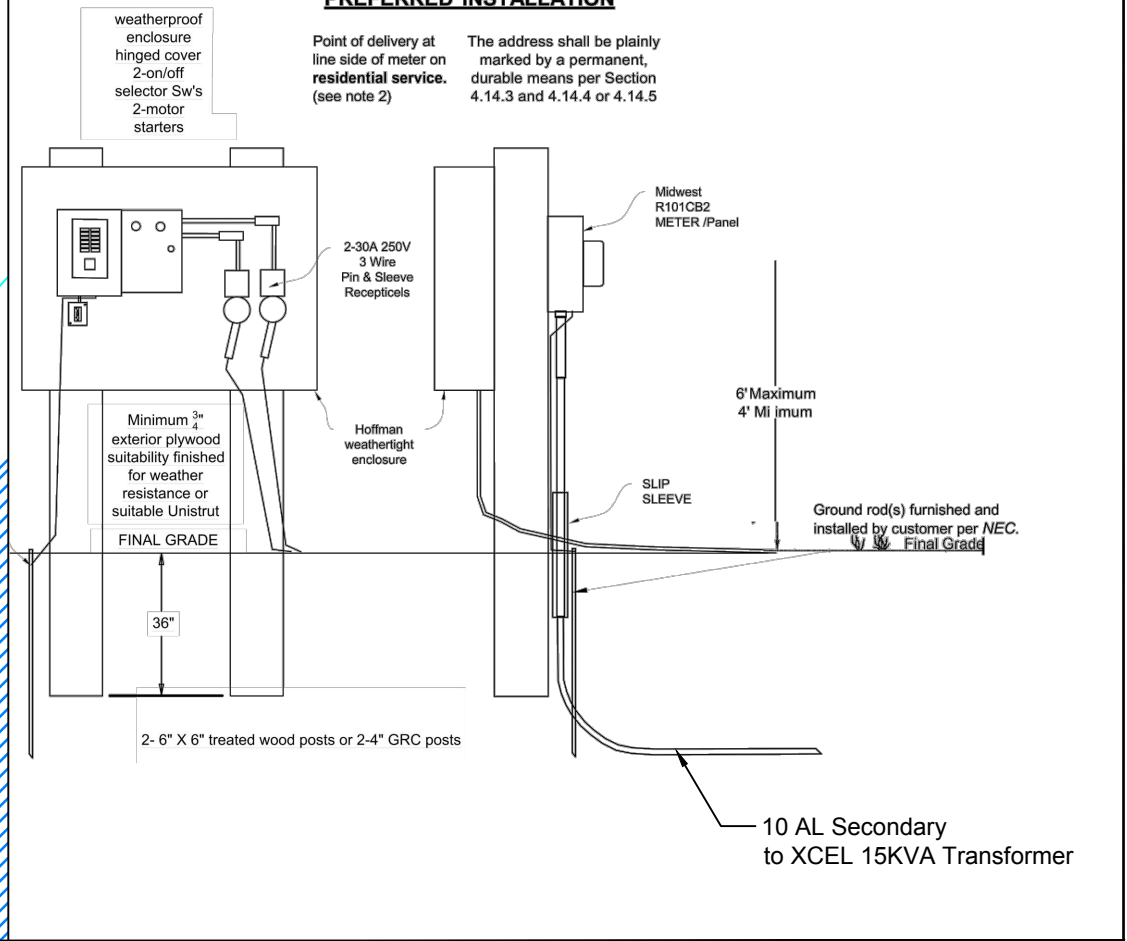

CONTACT PERSON: WAYNE BAUERNSCHMITT
 OFFICE: 320-558-9485
 CELL: 320-428-2481
 EMAIL: WAYNE.BAUERNSCHMITT@TELCOMCONSTRUCTION.COM

JOB: NORTH LUNDSTEN LAKE

SHEET #: 5 OF 8

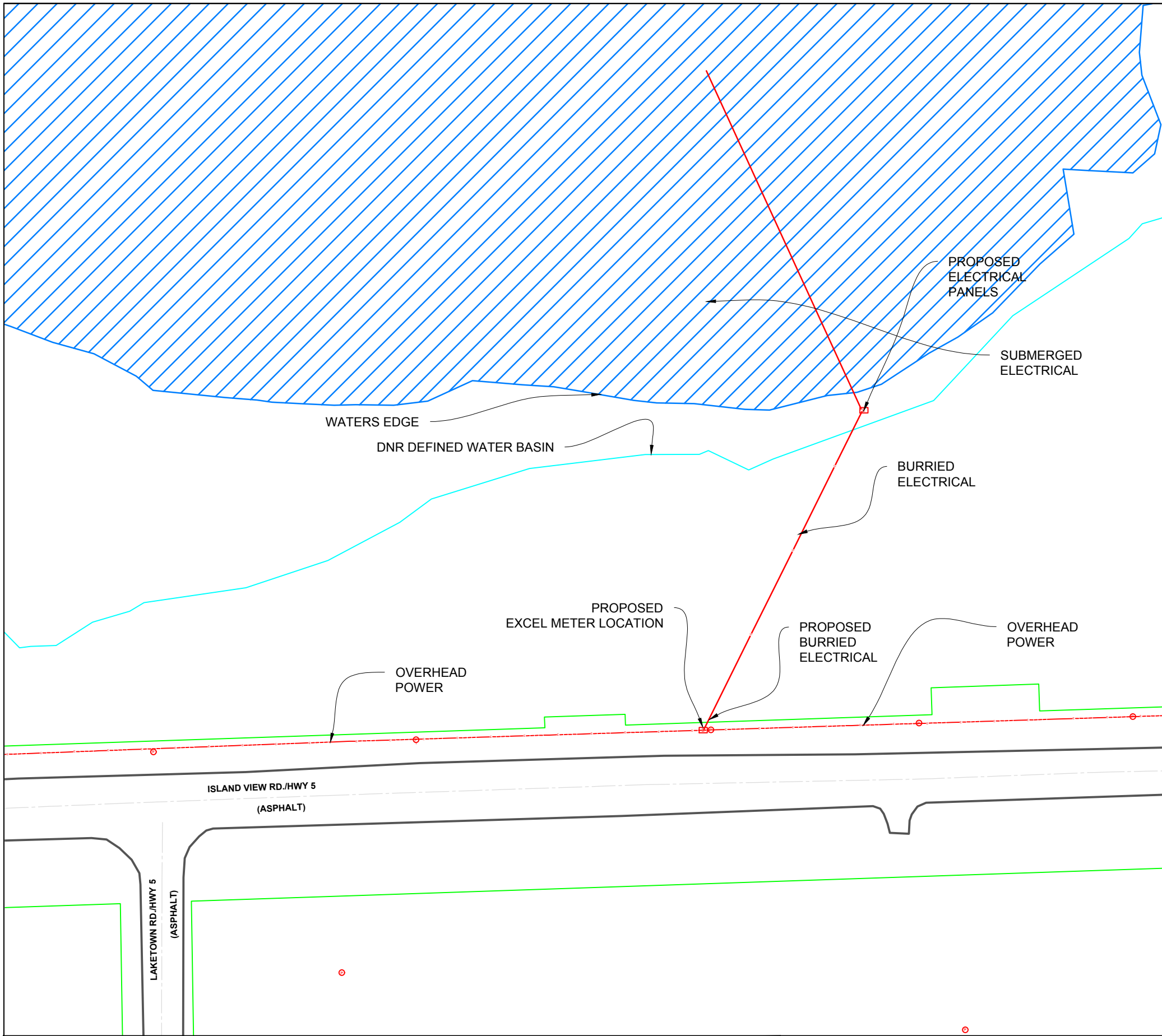

PREFERRED INSTALLATION

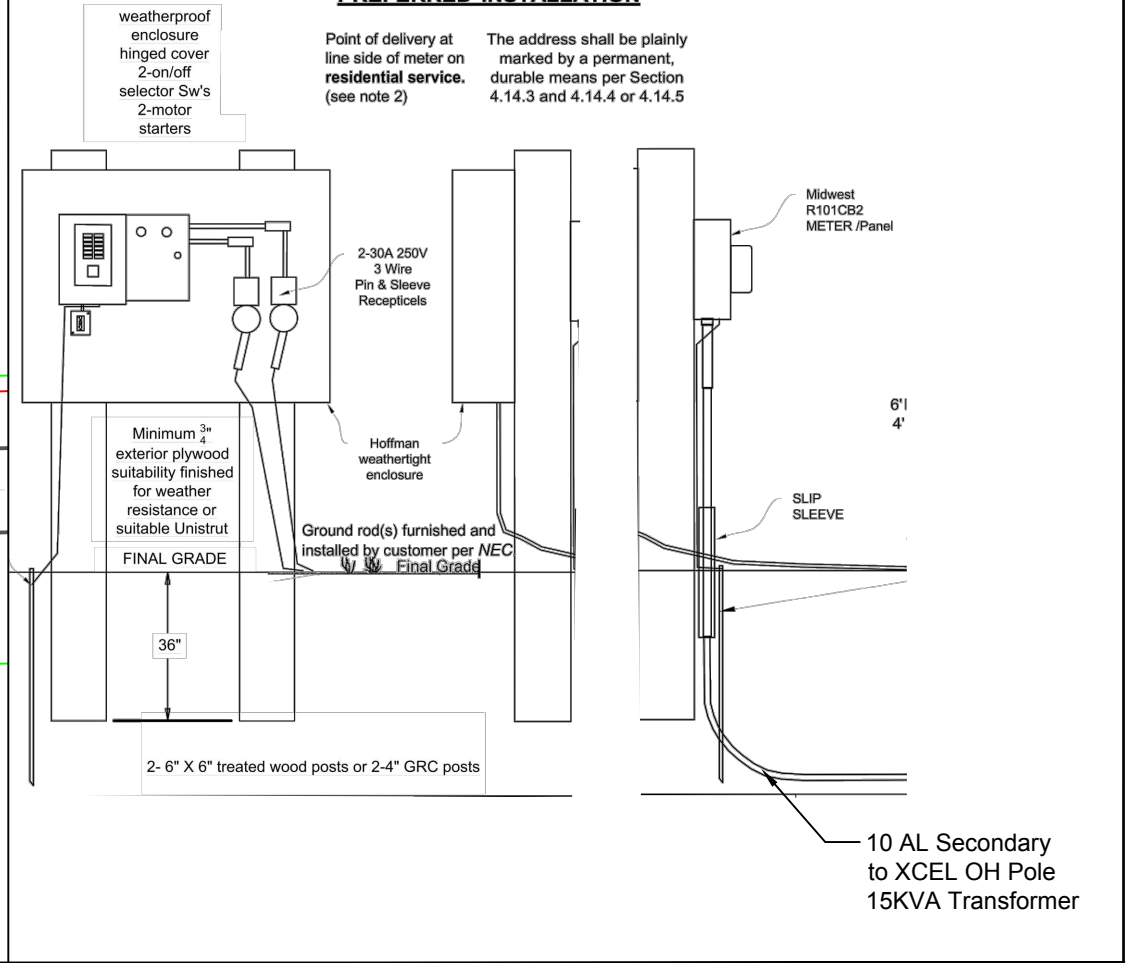

CONTACT PERSON: WAYNE BAUERNSCHMITT
 OFFICE: 320-558-9485
 CELL: 320-428-2481
 EMAIL: WAYNE.BAUERNSCHMITT@TELCOMCONSTRUCTION.COM

JOB: SOUTH LUNDSTEN LAKE

0' 100'
 SCALE: 1" = 100'
 SHEET #: 6 OF 8

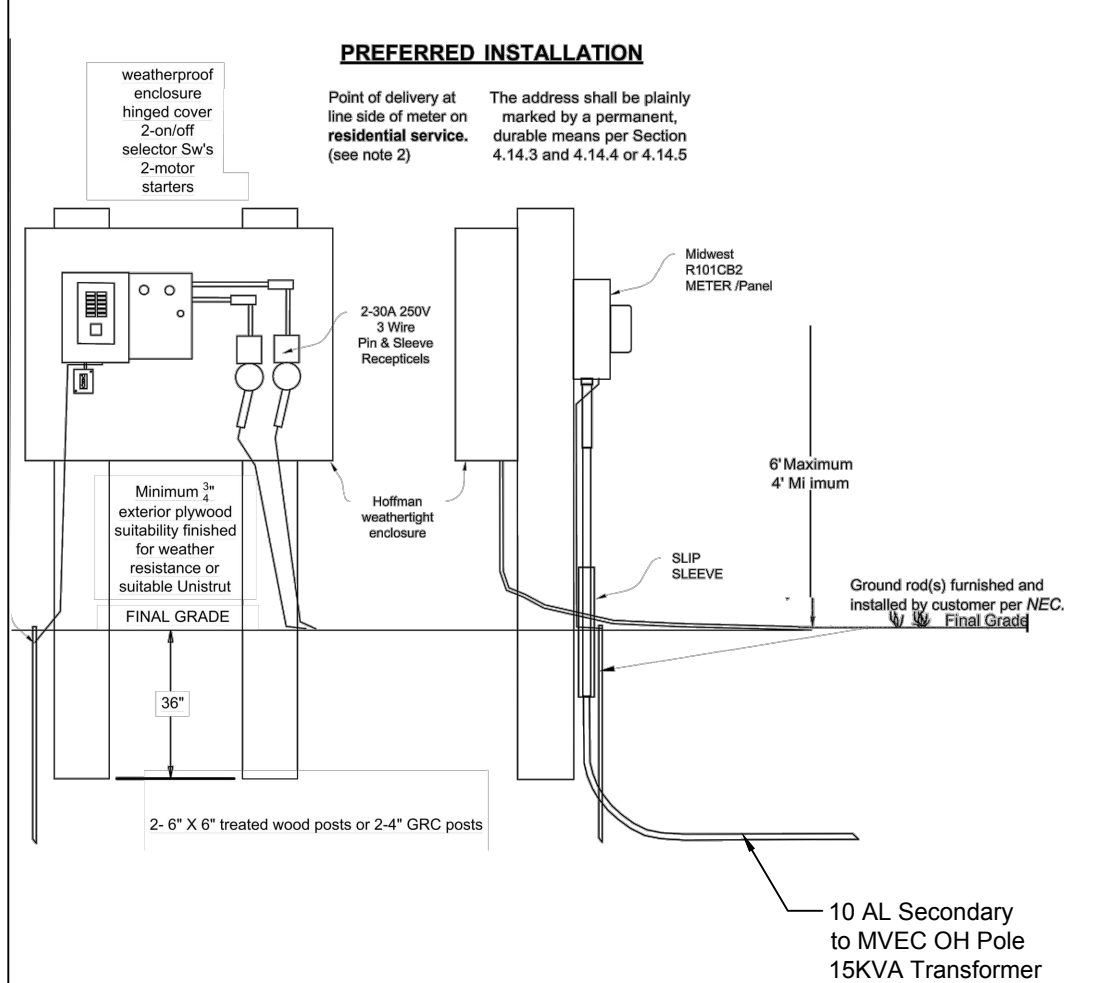
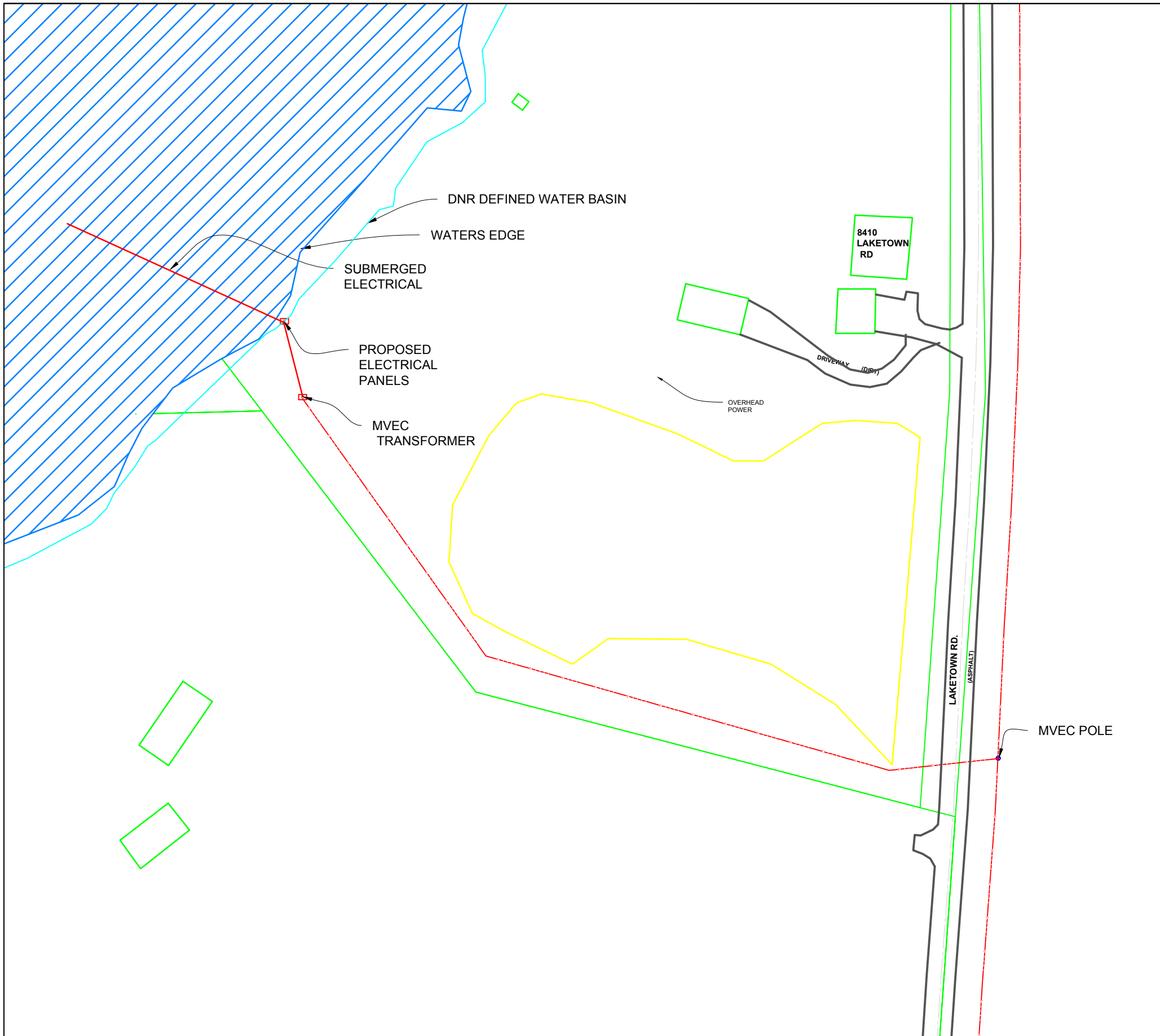

CONTACT PERSON: WAYNE BAUERNSCHMITT
 OFFICE: 320-558-9485
 CELL: 320-428-2481
 EMAIL: WAYNE.BAUERNSCHMITT@TELCOMCONSTRUCTION.COM

JOB: TURBID LAKE

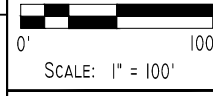

SHEET #: 7 OF 8

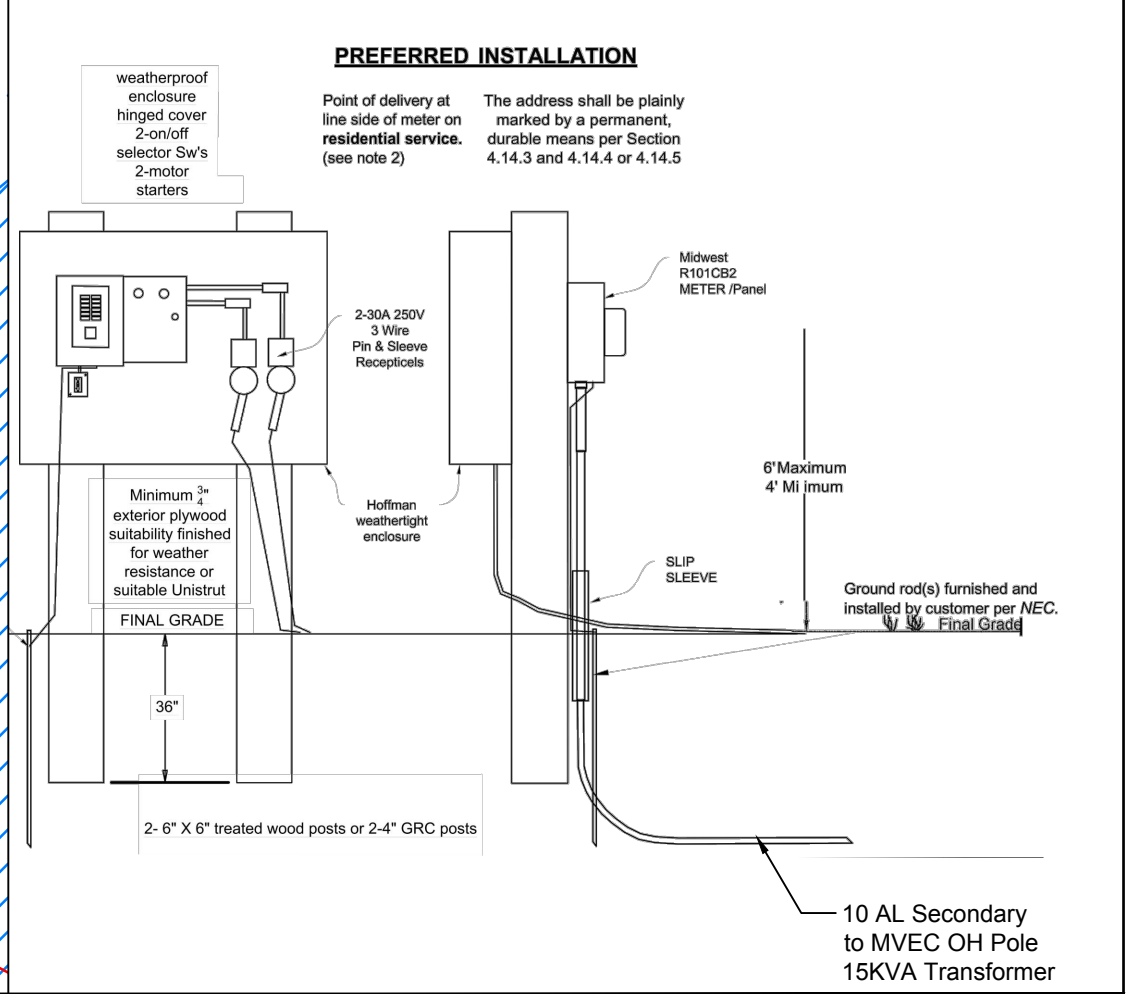
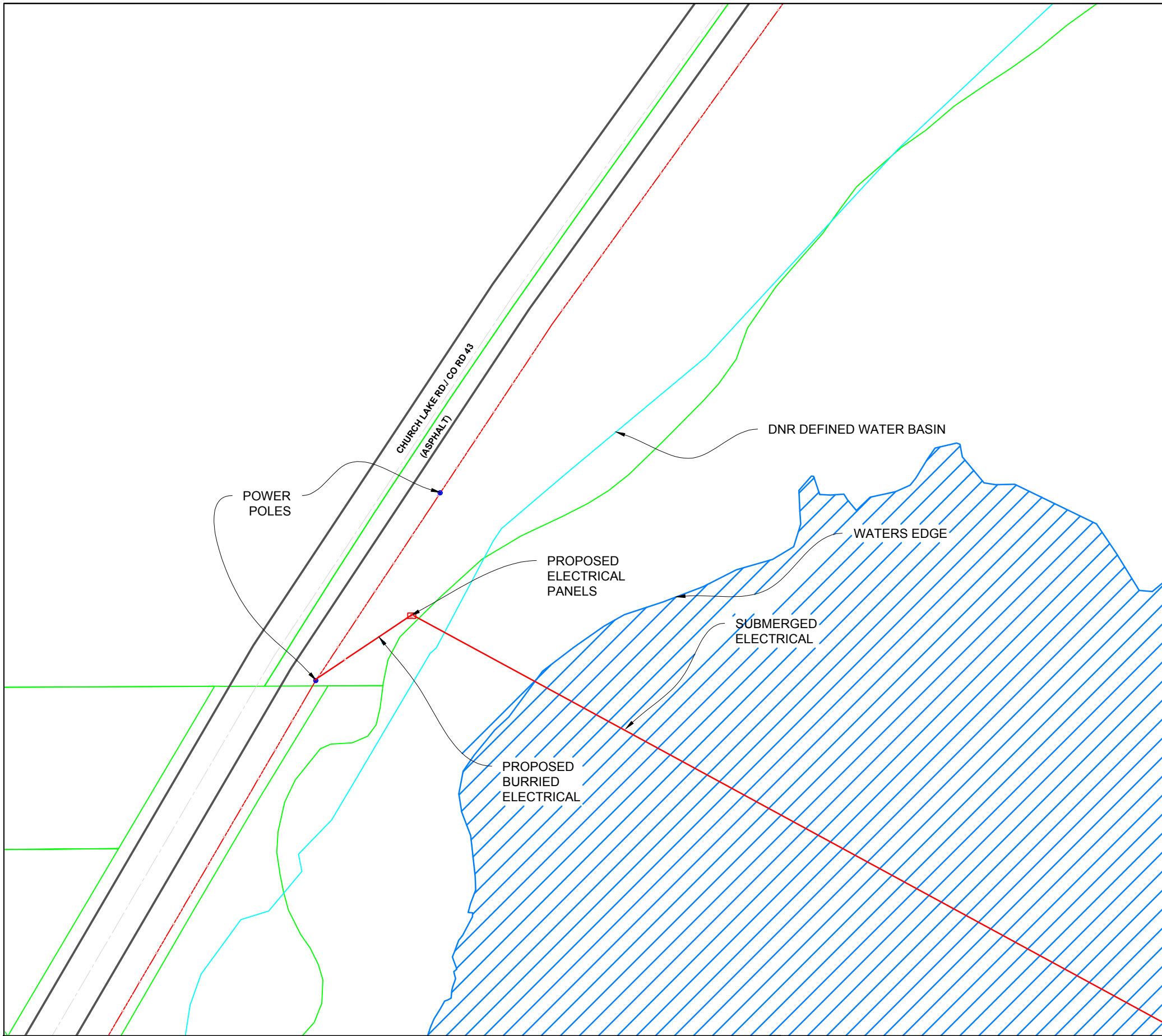

CONTACT PERSON: WAYNE BAUERNSCHMITT
 OFFICE: 320-558-9485
 CELL: 320-428-2481
 EMAIL: WAYNE.BAUERNSCHMITT@TELCOMCONSTRUCTION.COM

JOB: MARSH LAKE

SCALE: 1" = 100'

SHEET #: 8 OF 8

TELCOM CONSTRUCTION INC

2218 200th Street E. ~ P.O. Box 189

Clearwater, MN 55320

320-558-9485 ~ 320-558-9486

SUBMITTED TO Minnehaha Creek Watershed District	TELEPHONE 952-641-4522	DATE 10/23/2018
ADDRESS 15320 Minnetonka Blvd	PROJECT NAME SMCHB 6 mile Habitat Aeration Project	
CITY, STATE, ZIP Minnetonka, MN 55345	PROJECT LOCATION Hennepin and Carver County	
ENGINEER	TELCOM CONTACT PERSON Wayne Bauernschmit	TELEPHONE 952-641-4522

WE HEREBY SUBMIT SPECIFICATIONS AND ESTIMATES FOR:

MCWSD Mud Lake

Bore 235 Ft of 3 in Duct

Install 235 Ft of 4/ 0 Secondary installation in Duct (TCC/ MIDBROD)

Install H-frame & Post assembly (LAKELAND)

Meter post at Power Pole

Install electrical load center & motor controller with wiring connection

Wiring of Aerator Pump and Motor control

Lump sum bid for work as specified above:

\$14,704.50

MCWSD South Lundsten Lake

Plow 625 Ft of 3 in Duct

Install 625 Ft of 4/ 0 Secondary installation in Duct

Install H-frame & Post assembly

Meter post at Power Pole

Install electrical load center & motor controller with wiring connection

Wiring of Aerator Pump and Motor control

MNDOT / County Permit

Lump sum bid for work as specified above:

\$16,228.75

MCWSD Marsh Lake

Bore 125 Ft of 3 in Duct

Install 125 Ft of 4/ 0 Secondary installation in Duct

Install H-frame & Post assembly

Install electrical load center & motor controller with wiring connection

Wiring of Aerator Pump and Motor control

MNDOT / County Permit

Lump sum bid for work as specified above:

\$12,097.50

TELCOM CONSTRUCTION INC

2218 200th Street E. ~ P.O. Box 189

Clearwater, MN 55320

320-558-9485 ~ 320-558-9486

MCWSD Turbid Lake

Bore 65 Ft of 3 in Duct

Plow 875 Ft of Primary MVEC Cable

Install 55 Ft of 4/ 0 Secondary installation in Duct

Install H-frame & Post assembly

Install electrical load center & motor controller with wiring connection

Wiring of Aerator Pump and Motor control

MNDOT / County Permit

Lump sum bid for work as specified above: \$13,221.00

***Winter charges may apply due to delay is route access, ROW permitting, or property owner obstruction ***

WE PROPOSE HEREBY TO FURNISH MATERIAL AND LABOR -- COMPLETE IN ACCORDANCE WITH ABOVE SPECIFICATIONS FOR THE SUM OF:

Fifty Six Thousand, Two Hunderd Fifty One and 75/ 100 dollars (\$) \$56,251.75

PAYMENT TO BE MADE AS FOLLOWS:

Invoice upon Completion - Term 30 Days Net.

<p>ALL MATERIAL IS GUARANTEED TO BE AS SPECIFIED. ALL WORK TO BE COMPLETED IN A WORKMANLIKE MANNER ACCORDING TO STANDARD PRACTICES. ANY ALTERATION OR DEVIATION FROM ABOVE SPECIFICATIONS INVOLVING EXTR COSTS WILL BE EXECUTED ONLY UPON WRITTEN ORDERS, AND WILL BECOM AN EXTRA CHARGE OVER AND ABOVE THE ESTIMATE. ALL AGREEMENTS CONTINGENT UPON STRIKES, ACCIDENTS OR DELAYS BEYOND OUR CONTROL OWNERS TO CARRY FIRE, TORNADO AND OTHER NECESSARY INSURANCE. OUR WORKERS ARE FULLY COVERED BY WORKMEN'S COMPENSATION INSURANCE</p>	<p style="text-align: right;">TelCom Construction, Inc.</p> <p>AUTHORIZED SIGNATURE _____</p> <p style="text-align: right;">Dave Rantasha, Senior Vice President</p> <p>NOTE: THIS PROPOSAL MAY BE WITHDRAWN BY US IF NOT ACCEPTED WITHIN <u> 30 </u> DAYS.</p>
---	---

Customer

ACCEPTANCE OF PROPOSAL - THE ABOVE PRICES, SPECIFICATIONS AND CONDITIONS ARE SATISFACTORY AND ARE HEREBY ACCEPTED. YOU ARE AUTHORIZED TO DO THE WORK AS SPECIFIED. PAYMENT WILL BE MADE AS OUTLINED ABOVE.

DATE OF ACCEPTANCE _____ TITLE _____

TELCOM CONSTRUCTION INC
 2218 200th Street East P.O. Box 189
 Clearwater, MN 55320
 320-558-9485

SUBMITTED TO: Minnehaha Creek Watershed District	TELEPHONE: 952-641-4522	DATE 10.22.18
ADDRESS: 15320 Minnetonka Blvd,	PROJECT NAME : SMCHB 6 mile Habitat	
CITY, STATE, ZIP Minnetonka, MN 55345	PROJECT LOCATION: Hennepin and Carver County	
TCC Contact: Wayne Bauernschmitt Phone: 320-558-8548	Client CONTACT PERSON: Anna Brown	TELEPHONE 952-641-4522

UNITS	QUANTITY	Extended Cost	Total	Clients Additional Cost	Power Provider Clients Cost
MCWSD Mud Lake					
Bore 3 in Duct	235	\$ 3,701.25			
4/ 0 Secondary installation in Duct	235	\$ 1,868.25		\$2,150 Xcel New Service Aprox Charge	\$ 2,150.00
Install H-frame & Post assembly	1	\$ 1,950.00			
Meter post at Power Pole	1	\$ 250.00			
Install electrical load center & motor controller with wiring connection	1	\$ 6,350.00		Client to provide Aeration Pump and Umbilical	
Wiring of Aerator Pump and Motor control	1	\$ 585.00			
			\$ 14,704.50		
UNITS					
MCWSD Sunny Lake Not Quoted on Proposal					
Bore 3 in Duct	65	\$ 1,023.75			
4/ 0 Secondary installation in Duct	65	\$ 516.75		\$\$\$ Xcel New Service Charge Winter charges in place	
Install H-frame & Post assembly	1	\$ 1,950.00			
Meter post at Power Pole	1	\$ 250.00			
Install electrical load center & motor controller with wiring connection	1	\$ 6,350.00		Client to provide Aeration Pump and Umbilical	
Wiring of Aerator Pump and Motor control	1	\$ 585.00			
			\$ 10,675.50		
UNITS					
MCWSD North Lundsten Lake Not Quoted on Proposal					
Bore 3 in Duct	265	\$ 4,173.75			
4/ 0 Secondary installation in Duct	265	\$ 2,106.75		\$\$\$ Xcel New Service Charge Winter charges in place	
Install H-frame & Post assembly	1	\$ 1,950.00			
Meter post at Power Pole	1	\$ 250.00			
Install electrical load center & motor controller with wiring connection	1	\$ 6,350.00		Client to provide Aeration Pump and Umbilical	
Wiring of Aerator Pump and Motor control	1	\$ 585.00			
			\$ 15,415.50		
MCWSD South Lundsten Lake					
Plow 3 in Duct	625	\$ 1,875.00			
4/ 0 Secondary installation in Duct	625	\$ 4,968.75		\$2,150 Xcel New Service Charge	\$ 2,150.00
Install H-frame & Post assembly	1	\$ 1,950.00			
Meter post at Power Pole	1	\$ 250.00			
Install electrical load center & motor controller with wiring connection	1	\$ 6,350.00			
Wiring of Aerator Pump and Motor control	1	\$ 585.00		Client to provide Aeration Pump and Umbilical	
MNDOT / County Permit	1	\$ 250.00			
			\$ 16,228.75		
MCWSD Marsh Lake					
Bore 3 in Duct	125	\$ 1,968.75			
4/ 0 Secondary installation in Duct	125	\$ 993.75		\$2800 MVEC New Service Aprox Charge	\$ 2,800.00
Install H-frame & Post assembly	1	\$ 1,950.00			
Install electrical load center & motor controller with wiring connection	1	\$ 6,350.00			
Wiring of Aerator Pump and Motor control	1	\$ 585.00		Client to provide Aeration Pump and Umbilical	
MNDOT / County Permit	1	\$ 250.00			
			\$ 12,097.50		
MCWSD Turbid Lake					
Bore 3 in Duct	65	\$ 1,023.75			
Plow Primary MVEC Cable	875	\$ 2,625.00		\$6800 MVEC New Service Aprox Charge	\$6,800
4/ 0 Secondary installation in Duct	55	\$ 437.25			
Install H-frame & Post assembly	1	\$ 1,950.00			
Install electrical load center & motor controller with wiring connection	1	\$ 6,350.00			
Wiring of Aerator Pump and Motor control	1	\$ 585.00		Client to provide Aeration Pump and Umbilical	
MNDOT / County Permit	1	\$ 250.00	\$ 13,221.00		
Estimated Total, Not formal proposal			\$ 82,342.75		\$ 13,900.00
**Winter charges may apply due to delay is route access, ROW permitting, or property owner obstruction **			Total		Power Provider Clients Cost